



PRECISE PROCESSING, OUTSTANDING SERVICE

— 卓越精工 | 自然出众 —

给排水阀门系列 Water Supply&Drainage Valves

宁波杰克龙精工有限公司

地址：中国·宁波·慈城城西西路1号
Address: No.1 Chengxi West Road Cicheng Ningbo China
销售热线(Sales hotline): +86-574-87597291
服务热线(Service hotline): +86-574-87597992
全国免费服务热线(The free service hotline): 800-9574-099
投诉专线(Complaint special line): +86-574-87574567
传真(Fax): +86-574-87574862-1318
邮编(P.C.): 315034
网址(Http): www.jklong.com
电子信箱(E-mail): jklong@jkgroup.com.cn

JKLONG 10/2020

版权所有 禁止仿冒 All information are subject to changes without notice all copyright are reserved

JKLONG 杰克龙®
www.jklong.com



COMPANY PROFILE 公司简介

宁波杰克龙精工有限公司始建于1998年8月，系宁波金田铜业（集团）股份有限公司的子公司。宁波杰克龙精工有限公司专业生产各类铜阀门、铸钢铸铁阀门、燃气阀、水阀及各类管件等，是一家集研发、制造、销售和服务于一体的高新技术企业。产品广泛应用于给排水系统、燃气系统、城市供热、暖通空调及产品配套等领域，销售网络遍布全国，销售网点近500家，在中国中、低压民用铜阀门领域深加工中名列前茅。

杰克龙精工投资法人宁波金田铜业集团设立的企业技术中心，凭借自身完善的研发体制、雄厚的科技实力和丰硕的科研成果，被国家发改委认定为“国家级企业技术中心”。杰克龙精工先后通过了ISO9001、ISO14001和ISO45001三大管理体系认证，并于2018年11月获得“浙江制造认证证书”，是国内首家水阀、燃气阀产品双认证的企业，被认定为“高新技术企业”，杰克龙精工被评为“中国阀门知名品牌”。

公司坚持科技兴企理念，专注于产品的研发与技术创新，配备了行业领先的自动化生产设备，以定制金田铜棒为原料保证了产品的品质。公司专注于产品的研发与技术创新，拥有国家专利技术180余项，制定/参与国家标准20余项。公司率先引进智能化、国际化的生产装备及检测装备，拥有国际领先的、最高效、节能环保的意大利进口智能锻造线，拥有批量的数字化高精密度轴水车组合专利，拥有进口的全自动智能测漏装备线以及进口三坐标等装备。凭借一整套严格的产品管理体系和从原料到成品的全过程监控，有力保障了杰克龙产品的高品质，打造了杰克龙出众的品牌优势，赢得了广大用户的认可与信任。

面向未来，公司坚持“品牌共创，成就共享，合作共赢，和谐共建”的发展理念及“依法经营、诚信经营、自主创新、科学发展”的经营理念，以市场为导向，以客户为中心，坚持科技兴企，加快转型升级，优化产品结构，提升产品品质，争创“杰克龙”国内一流领军品牌和世界著名品牌。致力成为阀门行业标杆企业，为实现“世界级500强”的金田梦而不懈奋斗！“资源有限，利用无限”，公司坚持走循环经济和谐发展之路，秉承“天天求变，永不自满，勇于竞争，追求卓越”的企业精神，致力于让“杰克龙”成为业内第一品牌和世界著名品牌，用我们真诚的服务，开启您的美好生活。

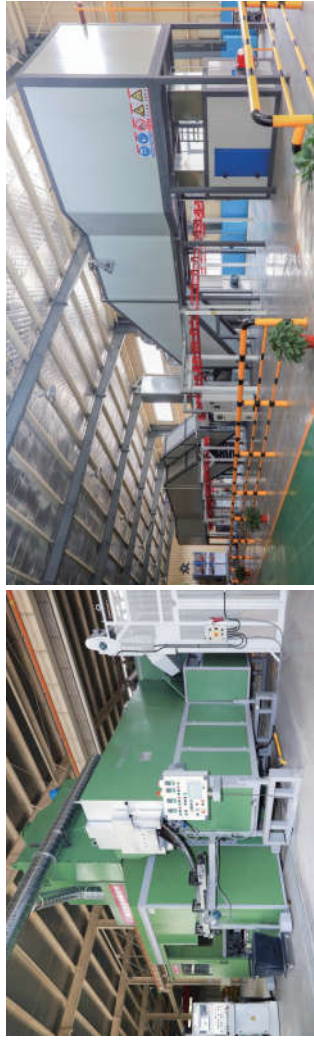

CONTENTS

目录

01-13	闸阀 Gate Valve
14-25	蝶阀 Butterfly Valve
26-29	止回阀 Check Valve
30-35	水力控制阀 Hydraulic Control Valve
36	截止阀 Stop Valve
37	球阀 Ball Valve
38	过滤器 Strainer
39-41	排气阀 Exhausting Valve
42-43	平衡阀 Balance Valve
44	自力式压差阀 Pressure Difference Self-control Valve
45	防污隔断阀 / 倒流防止器 Anti-Fouling Stop Valve / Backflow Preventers
46	水锤吸纳器 / 橡胶软接头 Water-Hammer Arrestor / Flexible Rubber Joint
47	补偿器 Compensator
48-51	不锈钢系列 Stainless steel series
52	销售服务网络 Sales network

闸阀 GATE VALVE

闸阀型号编制方法 (JB/T308-2004) ESTABLISHMENT METHOD OF GATE VALVE MODEL

闸阀型号由七个单元组成按下列顺序编制

The valve model is composed of seven units and is established according to the following sequence

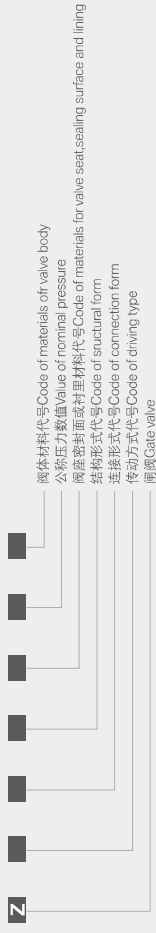

传动方式 Code of driving type

传动方式 Driving type	代号 Code	传动方式 Driving type	代号 Code
电磁动 Electromagnetic drive	0	伞齿轮 Bevel gear	5
电液动 Electromagnetic and hydraulic	1	气动 Pneumatic	6
液动 Hydraulic	2	液动 Hydraulic	7
蜗轮 Worm wheel	3	气液动 Pneumatic and hydraulic	8
正齿轮 Spur gear	4	电动 Electric	9

注: (1) 手柄、手柄和扳手传动以及安全阀、减压阀、疏水阀等代号, 参照本手册第9章表示。

Note: (1) For the safety Valve, pressure reducing Valve and drainable Valve with handwheel, handle and wrench driving, the code is omitted

(2) For pneumatic or hydraulic, the constant open type is expressed in 6K and 7K. The constant close type is expressed in 6B and 7B. Pneumatic and manual is expressed in 6S. Electric with anti-explosion is expressed in 9B.

连接形式 Code of connection form

连接形式 Connection form	代号 Code	外螺纹 External thread	法兰 Flange	焊接 Welding	对夹 But clamp	卡箍 Hoop	卡套 Ferrule
内螺纹 Internal thread	1	2	4	6	7	8	9

结构形式 Code of structural form

闸阀结构形式 Structural form of gate valve	代号 Code	弹性闸板 Flexible gate valve	代号 Code
明杆 Rising stem	楔型式 Wedge type 平行式 Parallel type	单闸板 Single fishboard	0
		双闸板 Double fishboard	1
		黄闸板 Single fishboard	2
暗杆 Non-rising stem wedge type	刚性 Rigid	双闸板 Double fishboard	3
		单闸板 Single fishboard	4
		双闸板 Double fishboard	5
		双闸板 Double fishboard	6

闸阀密封面或衬里材料代号 Code of materials for valve seat/sealing surface and lining

闸阀密封面或衬里材料 Code of materials for butterfly valve	代号 Code	闸阀密封面或衬里材料 Code of materials for butterfly valve	代号 Code
铜合金 Copper alloy	T	渗氮钢 Nitriding steel	D
橡胶 Rubber	X	硬合金 Hard alloy	Y
尼龙塑料 Nylon plastic	N	衬胶 Rubber lining	J
氟塑料 Fluorine plastic	F	搪瓷 Porcelain enamel	C
巴氏合金 Babbitt alloy	B	衬铅 Lead lining	Q
合金钢 Alloy steel	H	渗硼钢 Boron steel	P

注: 由阀体直接加工的闸阀密封面材料代号“W”表示; 当闸阀和闸阀(碟阀)密封面材料不同时, 用低硬度材料代号表示(闸阀除外)。

Note: The code of materials for valve seat and sealing surface processed directly by the valve body is expressed in "W". If the materials of valve seat and valve clack (fishboard) sealing surface are different, it shall be expressed in the code of materials with low hardness (Except the diaphragm valve)

公称压力数值 Value of nominal pressure

按 JB/T459 规定标注公称压力, 其试验力和工作压力“P”的规定: 用于电站工业的阀门, 当介质的最高温度超过 330°C 时, 按 JB/T459 第 5 条的规定, 标注工作压力。

The Value of nominal pressure shall be in accordance with the stipulations in JB/T459 "Nominal pressure, testing pressure and working pressure of valves". For the Valve used in power station industry, when the maximum temperature of the medium exceeds 330°C, according to the stipulations in Article 5 of JB/T459, note the working pressure.

阀体材料代号 Code of materials for valve body

阀体材料 Code of materials for valve body	代号 Code	阀体材料 Code of materials for valve body	代号 Code
灰铸铁 Cast iron	Z	铜合金 Copper alloy	T
可锻铸铁 Malleable cast iron	K	碳钢 Carbon steel	C
球墨铸铁 Ductile iron	Q	C15Mo	I
		12Cr1Ni9Ti	P
		1Cr18Ni12Mo2Ti	R
		12CrMoV	V

注: PN<16kgf/cm² 的灰铸铁阀体 PN<25kgf/cm² 的球墨铸铁阀体, 省略本单元。

Note: For the cast iron valve body with 16kgf/cm² and carbon steel valve body with PN<25kgf/cm², the unit is omitted.

弹性密封闸阀 1/4 解剖图

RESILIENT-SEATED GATE VALVE, 1/4 SECTION VIEW

止推轴承减少摩擦阻力降低操作扭力

The thrust bearing reduce frictional resistance and low down operating torsion

三只O型圈多层防护，密封可靠，且可实现带压更换O型圈。

Three O-rings for multi-layer protection, reliable sealing, and replace the O-rings under pressure.

精密加工阀杆，可减低操作扭力

Precisely producing the seam of valves, which low down operating torsion.

闸板采用橡胶完全包裹设计，连接牢固，寿命长，卫生达标。

The flashboard is completely covered with rubber firmly. The rubber is safe, durable and hygienic.

阀体底部无凹槽，不易造成杂物淤积

The bottom of valve is plain, not easy to block up by debris.

产品采用无毒环氧树脂粉末喷涂，顶级的设备，先进的工艺保证了产品漆流厚度均匀，外观光滑。

The whole products are dipped and coated with non-toxic epoxy resin powder electrostatically. With the support of the top equipments and advanced technologies, the products are with the uniform dip coating, thickness and the smooth appearance.

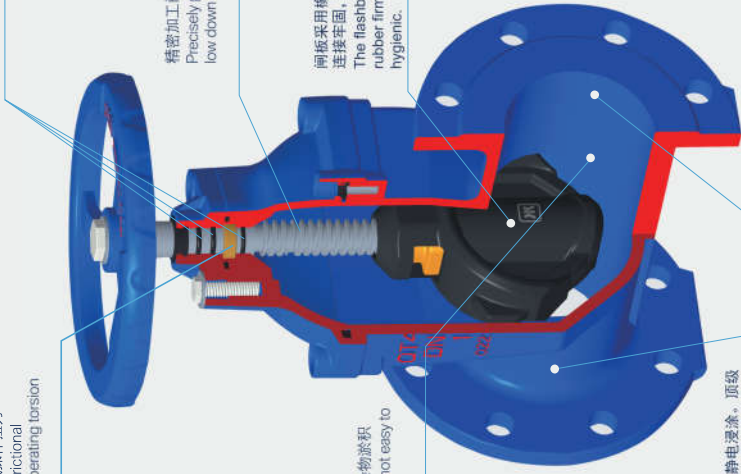

弹性密封闸阀
ELASTIC-SEAT ENCLOSED GATE VALVE

结构特点及用途
Structures Characteristics And Usage

该产品引进欧洲高科技橡胶及阀门制造技术生产的，克服了橡胶老化及生锈等缺陷。该闸利用弹性闸板产生微量弹性变形的补偿作用达到良好的密封效果。该闸具有开关轻巧、密封可靠、弹性记忆佳及使用寿命长等明显优点。产品广泛用于自来水、污水、海水、水处理、环保、建筑、石油、化工、电力、食品、医药、轻纺、船舶、能源等行业管路线上作为调节和截流装置作用。

This product is made by means of importing the high-tech rubber and the know-how of valve manufacture of Europe and over comes the defectives as rubber aging and rust etc. It uses the compensating action from the micro-deformation of elasticity produced by the elastic gate plate to get the good sealing effect and features the advantages of light on-off, reliable sealing, good memory of elasticity, long duration and so on. It can be used as the adjust and shutoff device on the pipeline in tap water, sewage, seawater, water treatment, environmental protection construction, petroleuno chemical industry, electric powero food medicine, Light&textile industry, ship, energy source etc.

平底式阀座 Flat-bottom valve seat

一般闸阀往往在通水冲洗管道后即因外物诸如水泥块、铁屑等杂物淤积于阀门底部槽内，容易造成无法关闭紧密而形成漏水现象，弹性座密封闸阀底部采用与管道相同的平底设计，不易造成杂物淤积，使流体畅通无阻。

For the common gate valves, it is easy to make it unable to tightly close the valve and thus resulting in leakage after being rinsed with water because of the foreign matters such as stones, wood blocks, cement, ferric bits, sundw things etc which are piled up inside of the concave slot on the valve bottom. The elastic-seat enclosed gate valve uses the same design of flat-bottom as that of the pipeline so as not to be easy to get sundry matters piled up thus making the fluid smoothly flowing without any resistance

重量轻 Light weight

本闸采用高级球墨铸铁制成，重量较传统闸阀重量减轻约20%-30%，安装维修方便。

This valve is made of high-quality Ductalloy, resulting in a reduction of weight by about 20%-30% of that of the traditiona ones and an easy installation and service.

精铸阀体 Finely casted

阀体采用精密铸造，精确的几何尺寸使阀体内部无需任何加工即可保证阀门的密封性。

The valve chest is finely casted and the accurate geometric sizes. Of it makes the internal part unnecessary for processor for assuring the valve to be lseely sealed.

闸板包胶 Rubber-wrapped valve plate

闸板采用高品质橡胶进行整体内外包胶。欧洲一流的橡胶硫化技术使得硫化后的闸板能够保证精确的几何尺寸。且橡胶与球墨铸铁板附着力强，不易脱落及弹性记忆佳。

The valve plate is overally and inside and out-side wrapped with the rubber of top grade and the first-rate know-how of rubber sulphurization of Europe makes the sulphurized valve plate's geometric size assured with accuracy and the joint between the rubber and the ductalloy valve plate reliable, not easy to fall out and leaves a good elastic memory.

“O”型环密封圈 Three O-type sealing rings

由于闸杆与闸盖采用三道“O”型环密封圈密封设计，可减少开关时的摩擦阻力。大幅度减少漏水现象及可以不停管路内介质流动进行更换密封圈。

The desig of three O-type sealing rings used between both valve rod and valve cover can reduce the frictional resistance at open or close and water leakage a great deql, and the sealing ring can be replaced without stopping the medium to flow inside of the pipeline

不易碎裂 Not fragile

以往传统低压闸阀采用铸铁，常因外物碰撞或重压而造成断裂等现象。由于本闸阀体采用球墨铸铁，此种情形已可大幅度减少。

The traditional low-pressure gate valves are made of cast-iron and often made broken or fragmented when suffered a collision by a foreign object or a heavy press, which is greatly reduced to the valve chest of this valve due to the Ductalloy of which it is made.

有助生饮 Helpful to unc-cooked drinking

由于阀体内部以无毒环氧树脂涂装。闸板的内外表面均以橡胶完全被覆而不于出现铁水或腐蚀现象。可供生饮。

Because of the non-toxic epoxy resin coated on the internal of the valve chest and the rubber wrapped completely on both inner and outer su rfaces of the valve plate, no ferric water or corrosion would occur, thus being helpful to uncooked drinking

省力装置 Labour-saving device

DN450-600mm，可另行加装省力装置。所需扭力约为正常的1/2。仅需一只小手柄。在有压力情况下。即可操作全开或全关。该省力装置于每次操作一次，需先将阀门全开后被复扭力功能。

To DN450-600mm, the labour-saving device as shown in the figure on right-down can be additionally mounted to which, the required torque is about 1/2 of the one under the normal condition and, with a small handwheel only. At every time of action, the labour-saving function of the device will not be reset until the valve is fully opened

**弹性密封闸阀
RESILIENT-SEATED GATE VALVE**

Z45X

1101

弹性密封闸阀
Resilient-Seated Gate Valve

Z45X

1103

带传动罩弹性密封闸阀
Elastic-Seal Enclosed Gate Valve

Z45X

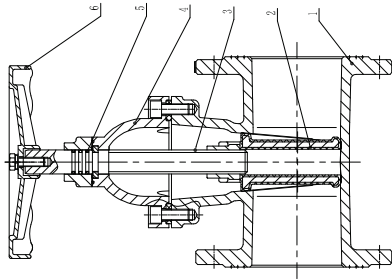

1. 阀体 Body
2. 闸板 Flashboard
3. 闸杆 Stem
4. 闸盖 Bonnet
5. O型圈 O-ring
6. 手轮 Handwheel

主要技术参数 Technical specifications for main part

公称通径DN (mm) Nominal diameter	50~600
公称压力PN (MPa) Nominal pressure	1.0 1.6
额定行程h (mm) Rated travel	全开 Full open
工作温度T (°C) Working temperature	≤80
允许泄漏量 Allowable leakage	A级 GB/T13927-2008

本产品性能指标贯彻GB/T12232-2005标准。
Techniques and performance of the valve implement GB/T12232-2005.

结构特点及用途 Structural Features and Applications

本闸选材精良，承压部件为高强度铸铁；闸板包胶；表面采用无毒环氧树脂静电喷涂，不会造成污物淤积，更适用于污水工况；与老式闸阀相比具有：重量轻、结构长度短、开关更省力、维修方便、使用寿命长等优点；广泛应用于自来水、污水处

理、冶金、石油、建筑、化工、电力等行业。适用介质为：水、气、油品等。
The valve adopts superior materials and is made of pressure parts with high-strength cast iron and rubber-coated disc. It can be used to drinking water pipes for its surface is coated with harmless EPOXY electrostatic spray. The body is designed with no slot in order to avoid dirt siltation. Compared to the old valve, the new kind has the advantages of light weight, short length, long life and is easy to use and maintain. It is widely used in drinking water pipes, sewage treatment, metallurgy, petroleum, construction, chemical, electric power and other industries. Applicable medium: Water, gas and oil.

主要零件材料 Material For Main Parts

零件名称 Name of Parts	材质 Material
阀体 Body	球墨铸铁QT450 Nodular cast iron
闸板 Flashboard	球墨铸铁QT450+三元乙丙橡胶EPDM Nodular cast iron and EPDM
闸杆 Stem	不锈钢 20Cr13 Stainless steel
闸盖 Bonnet	球墨铸铁QT450 Nodular cast iron
O型圈 O-ring	丁腈橡胶NBR Nitrile rubber

主要外形尺寸 Main External Dimenions

公称通径DN(mm) Nominal diameter	50	65	80	100	125	150	200	250	300	350	400	450	500	600
	L	178	190	203	229	254	267	292	330	356	381	406	432	457
D	PN10	165	185	200	220	285	340	395	445	505	565	615	670	780
PN16	165	185	200	220	250	285	340	405	460	520	580	640	715	840
PN10	125	145	160	180	210	240	295	350	400	460	515	565	620	725
PN16	125	145	160	180	210	240	295	355	410	470	525	585	650	770
h-obj	PN10	4-19	4-19	8-19	8-19	8-23	12-23	12-28	12-28	16-23	16-28	20-28	20-28	20-31
PN16	4-19	4-19	8-19	8-19	8-19	8-23	12-23	12-28	12-28	16-31	16-31	20-31	20-34	20-37
H	1101	198	225	275	315	340	420	515	621	710	869	923	1169	1554
1103	300	310	330	365	380	450	560	620	700	785	855	950	1050	1200
1105	325	335	370	413	535	550	720	882	1009	1300	1380	1470	1600	1705
1149	190	220	250	288	310	382	450	600	690	850	900	1150	1540	1830
Hmax	372	397	430	520	706	731	936	1132	1309	1650	1780	1920	2100	2305

注：法兰标准按GB/T17241.6 RF标准制造，也可按用户指定的标准制造，如JIS、ANSI、DIN。

Note: The manufacturer's standard of the external dimensions implement the GB/T17241.6 RF. The standard of JIS, ANSI, DIN are also available by the clients requirement.

1168

丝口弹性密封闸阀
Silk Mouth Resilient-Seated Gate Valve

Z15X

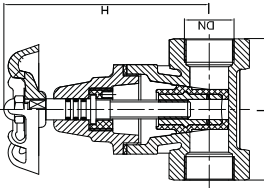

1119

磁性球式丝口弹性密封闸阀
Magnetic Looking Silk/Mouth Resilient-Seated Gate Valve

Z15X

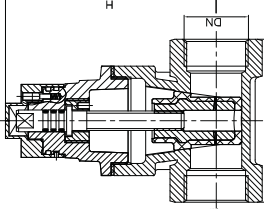

主要技术参数 Techniacal specifications for main part

公称通径DN (mm) Nominal diameter	15~100
公称压力PN (MPa) Nominal pressure	1.0 1.6
额定行程h (mm) Rated travell	全开 Full open
工作温度T (°C) Working temperature	≤80
允许泄流量 Allowable leakage	A级 GB/T13927-2008

本产品按指控贯彻GB/T8464-2008标准。
Techniques and performance of the valve implement GB/T 8464-2008.

特点及优点

丝口软密封闸阀利用闸板整体包胶产生变形补偿作用达到良好的密封效果, 克服了一般闸阀密封不良, 漏水生锈的现象, 底部采用与水管道相同的平底阀座设计, 不产生杂物淤积, 流阻系数小, 通道流畅。阀体内外采用无毒环氧树脂涂装, 防止腐蚀和生锈, 不但可供生活用水, 也可用于污水处理系统。广泛用于自来水、污水、建筑、石油化工、食品、医药和节能装置使用。平底式阀座使阀体密封线作为调节和节流装置使用。平底式阀座使阀体密封线在通水时于阀底凹槽内, 容易造成无法关闭严密而形成漏水现象, 软密封闸阀底部采用与水管道相同的平底设计, 不造成杂物淤积, 使流体通畅无阻。适用介质为: 水、气、油品等。

Features and advantages

Silk mouth soft-sealing gate valve by synthetic rubber deformation compensation effect overall package to achieve good sealing effect, overcomes the general gate seat bad, leakage and rusty phenomenon, bottom part using the same flat as the pipe seat design, do not produce sundry sedimentation, small flow resistance coefficient, smooth channels. Inside and outside the body USES the non-toxic epoxy resin coating to prevent corrosion and rust, not only available for domestic water. can also be used in sewage water treatment system. Widely used in tap water, sewage, construction, petroleum chemical industry, food, medicine, light textile, electric power, ships, metallurgy energy systems such as fluid pipe used as adjustment and throttling device. Flat type seat after the traditional gate often wash the tube in the water because of outside such as stone, wood, cement, paper scraps, sundry silt deposition on the bottom of the valve such as the slots, easy to cause cannot close tightly and form slack phenomenon, soft-sealing gate valve using the same as the pipe at the bottom of the flat design, not easy to cause debris deposition, the fluid flow unimpeded. Applicable medium: Water, gas and oil.

主要外形尺寸 Main External Dimensions

公称通径DN(mm) Nominal diameter	15	20	25	32	40	50	65	80	100
连接螺纹G Silk Mouth	1/2	3/4	1	1 1/4	1 1/2	2	2 1/2	3	4
H	97	97	105	125	145	160	205	240	285
L	65	70	80	95	100	110	130	144	168

PN10/16

1123

明杆铜芯密封闸阀
Copper Core Sealed Open Rod Gate Valve

Z41T

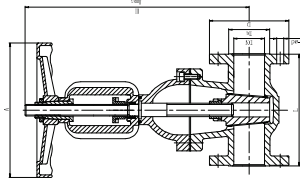

1124

铜芯密封闸阀
Copper Core Sealed Gate Valve

Z45T

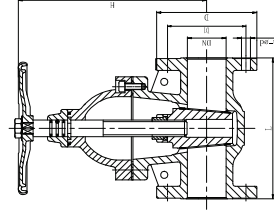

主要技术参数 Techniacal specifications for main part

公称通径DN (mm) Nominal diameter	50-200
公称压力PN (MPa) Nominal pressure	1.0 1.6
额定行程h (mm) Rated travell	全开
工作温度T (°C) Working temperature	≤80
允许泄流量 Allowable leakage	D级 GB/T13927-2008

本产品性能指贯彻GB/T12232-2005标准。
Techniques and performance of the valve implement GB/T12232-2005.

结构特点及用途 Structural Features and Applications

本阀是一种密封面接触的低压闸阀, 内部介质直通, 流阻小, 结构简单, 广泛应用于饮用水、给排水、废水污水处理、建筑、消防、石油、化工、食品、制药、轻纺、电力、冶金、能源系统等流体管线上作为调节和截流装置使用。
The valve is a low-pressure gate valve by the sealing plane of copper touching, internal direct, low flow resistance, simple construction, and it is widely used in drinking water pipes, water supply and drainage, sewage treatment, construction, fire control, petroleum, chemical, food, pharmacy, light textile, electric power, metallurgy, energy system and other industries for regulating flow.

主要外形尺寸 Main External Dimensions

公称通径DN(mm) Nominal diameter	50	65	80	100	125	150	200
L	183	190	203	229	254	267	292
D	PN10	176	195	215	244	281	341
	PN16	160	176	195	215	244	341
D1	PN10	125	145	160	180	210	240
	PN16	125	145	160	180	210	240
n-φd	PN10	4-φ19	4-φ19	8-φ19	8-φ19	8-φ19	8-φ23
	PN16	4-φ19	4-φ19	8-φ19	8-φ19	8-φ23	1.2-φ23
H	1123	320	390	400	548	710	895
	1124	252	273	314	387	427	553
Hmax	345	363	430	450	610	785	995

注: 法兰标准按GB/T17241.16 RF标准制造, 也可按用户指定的标准制造, 如JIS, ANSI, DIN。

Note: The manufacturer's standard of the external dimensions implement the GB/T17241.16 RF. The standard of JIS, ANSI, DIN are also available by the clients requirement.

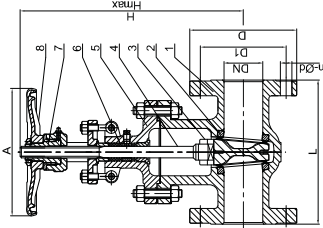

3101 铸钢密封闸阀
CAST STEEL GATE VALVE

Z41H

1. 阀体Body
2. 阀座Seat
3. 闸板Flashboard
4. 闸杆Stem
5. 阀盖Bonnet
6. 填料Packing
7. 传动螺母Driving nut
8. 手轮Handwheel

主要技术参数 Technicall specifications for main part

公称通径DN (mm) Nominal diameter	50~600
公称压力PN (MPa) Nominal pressure	1.6 2.5
额定行程h (mm) Rated travel	全开 Full open
工作温度T (°C) Working temperature	-20~200
允许泄漏量 Allowable leakage	GB/T26480

主要零件材料 Material For Main Parts

零件名称 Name of Parts	材质 Material
阀体 Body	铸钢WCB Carbon steel WCB
阀座 Seat	铸钢WCB Carbon steel WCB
闸板 Disc	铸钢WCB Carbon steel WCB
闸杆 Stem	不锈钢20Cr13 Stainless steel
阀盖 Bonnet	铸钢WCB Carbon steel WCB
填料 Packing	聚四氟乙烯PTFE

本产品性能指标贯彻GB/T12234-2007标准。

Techniques and performance of the valve implement GB/T12234-2007

结构特点及用途 Structural Features and Applications

阀门承压件采用精密铸造工艺浇铸，表面质量高，可采用铸钢或铸铝，造型配合手轮，适当增加摩擦力，方便开启，并带有明显的“开”、“关”标志。闸杆螺母采用高强度球铁，“T”形螺纹与闸杆配合传递力矩。阀盖设有油杯，可定期补充固体润滑油，保持轻松启闭。填料压紧和压套分体设计，填料压紧均匀，保证阀杆在使用的同心度。合理的填料函设计，确保阀门没有外漏，符合环保要求。Each component of this valve is using exaactitude cast technic. With malleable cast iron handwheel, it enjoys easy open advantage by adding proper friction and an obvious mark of "open" and "close". Stem nut which is made of high nickel-iron together with "T"-pattern screw can pass torque. The oil cup on the bonnet allows adding solid lube to keep smooth open and close. Packing share the pressure evenly to ensure the concentricity during usage and packing gland are reasonable designed to ensure there is no leakage, which also meets the requirement of environment protection.

主要外形尺寸 Main External Dimensions

公称通径DN(mm) Nominal diameter	PN16/25													
	50	65	80	100	150	200	250	300	350	400	450	500	600	
L	PN16	250	265	280	300	350	400	450	500	550	600	650	700	800
	PN25	165	185	200	220	285	340	405	460	520	580	640	715	840
D	PN16	165	185	200	235	300	360	425	485	555	620	670	730	845
	PN25	125	145	160	180	240	295	355	410	470	525	585	650	770
D1	PN16	125	145	160	190	250	310	370	430	490	550	600	660	770
	PN25	125	145	160	190	250	310	370	430	490	550	600	660	770
n-Ød	PN16	4-18	8-18	8-18	8-18	8-22	12-22	12-26	12-26	16-26	16-30	20-30	20-33	20-36
	PN25	4-18	8-18	8-18	8-18	8-26	12-26	12-30	16-33	16-36	20-36	20-36	20-39	20-39
H	PN16	415	450	530	605	850	1060	1225	1415	1630	1780	2050	2180	2600
	PN25	415	450	530	605	850	1060	1225	1415	1630	1780	2050	2180	2600
Hmax	PN16	465	515	610	705	1000	1260	1475	1715	1980	2180	2500	2680	3200
	PN25	465	515	645	690	1030	1340	1510	1715	1980	2180	2500	2680	3200

注：法兰标准按GB/T9124.1 RF标准制造，也可按用户指定的标准制造，如JIS、ANSI、DIN。

Note: The manufacturer's standard of the external dimensions implement the GB/T9124.1 RF. The standard of JIS、ANSI、DIN are also available by the clients requirement.

1191

消防闸阀（法兰暗杆）
Fire Protection Gate Valve Flanged with Non Rising Stem

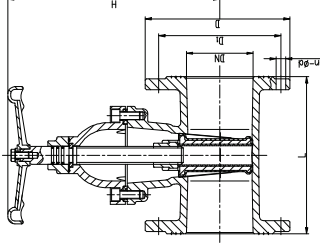

1195

消防闸阀（法兰明杆）
Fire Protection Gate Valve Flanged with Rising Stem

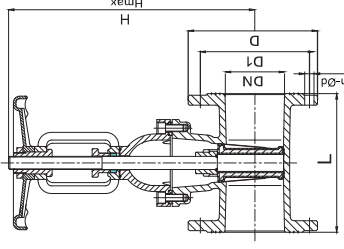

主要外形尺寸 Main External Dimensions

公称通径DN(mm) Nominal diameter	PN16										
	50	65	80	100	125	150	200				
L	178	190	203	229	254	267	292				
	165	185	200	220	250	285	340				
D	125	145	160	180	210	240	295				
	4-19	4-19	8-19	8-19	8-19	8-23	12-23				
D1	125	145	160	180	210	240	295				
	4-19	4-19	8-19	8-19	8-19	8-23	12-23				
n-Ød	4-19	4-19	8-19	8-19	8-19	8-23	12-23				
	198	225	293	303	340	417	515				
H	322	332	350	420	581	581	736				
	372	397	430	520	706	731	936				

注：法兰标准按GB/T17241.6 RF标准制造，也可按用户指定的标准制造，如JIS、ANSI、DIN。

Note: The manufacturer's standard of the external dimensions implement the GB/T17241.6 RF. The standard of JIS、ANSI、DIN are also available by the clients requirement.

1192

消防闸阀 (沟槽暗杆)
Fire Protection Gate Valve Grooved with Non Rising Stem

1193

消防信号闸阀 (法兰信号)
Fire Signal Gate valve Flanged

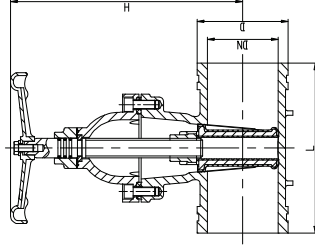

1196

消防闸阀 (沟槽明杆)
Fire Protection Gate Valve Grooved with Rising Stem

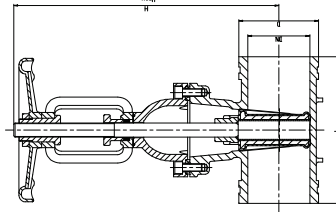

主要外形尺寸 Main External Dimensions

公称通径DN(mm) Nominal diameter	50	65	80	100	150	200
L	143	149	161	180	226	243
D	60.3	76.1	88.9	114.3	165.1	219.6
H	1192	250	290	315	410	535
	1196	324	327	420	550	742
Hmax	374	392	450	520	700	942

注：产品设计标准：GB5135.6标准制造，也可按用户指定的标准制造，如JIS、ANSI、DIN。
Note: The manufacturer's standard of the external dimensions implement the GB5135.6 RF. The standard of JIS、ANSI、DIN are also available by the clients requirement.

1194

消防信号闸阀 (沟槽信号)
Signal Gate valve Grooved

主要零件材料 Material For Main Parts

零件名称 Name of Parts	材质 Material
阀体 Body	球墨铸铁QT450 Nodular cast iron
闸板 Flashboard	球墨铸铁QT450+丁腈橡胶NBR Nodular cast iron and NBR
阀杆 Stem	不锈钢 20Cr13 Stainless steel
闸盖 Bonnet	球墨铸铁QT450 Nodular cast iron
O型圈 O-ring	丁腈橡胶NBR Nitrile rubber

主要外形尺寸 Main External Dimensions

公称通径DN(mm) Nominal diameter	50	65	80	100	125	150	200
L	178	190	203	229	254	287	292
D	165	185	200	220	250	285	340
D1	125	145	160	180	210	240	295
n-φd	4-19	4-19	8-19	8-19	8-19	8-23	12-23
H	198	225	293	303	340	417	515

1194

消防信号闸阀 (沟槽信号)
Signal Gate valve Grooved

主要零件材料 Material For Main Parts

零件名称 Name of Parts	材质 Material
阀体 Body	球墨铸铁QT450 Nodular cast iron
闸板 Flashboard	球墨铸铁QT450+丁腈橡胶NBR Nodular cast iron and NBR
阀杆 Stem	不锈钢 20Cr13 Stainless steel
闸盖 Bonnet	球墨铸铁QT450 Nodular cast iron
O型圈 O-ring	丁腈橡胶NBR Nitrile rubber

主要外形尺寸 Main External Dimensions

公称通径DN(mm) Nominal diameter	50	65	80	100	150	200
L	143	149	161	180	226	243
D	60.3	76.1	88.9	114.3	165.1	219.6
H	250	280	290	315	410	535

注：产品设计标准：GB5135.6标准制造，也可按用户指定的标准制造，如JIS、ANSI、DIN。
Note: The manufacturer's standard of the external dimensions implement the GB5135.6 RF. The standard of JIS、ANSI、DIN are also available by the clients requirement.

蝶阀型号编制方法 (JB/T308-2004)
ESTABLISHMENT METHOD OF BUTTERFLY VALVE MODEL

蝶阀型号由七个单元组成按下列顺序编制

The valve model is composed of seven units and is established according to the following sequence

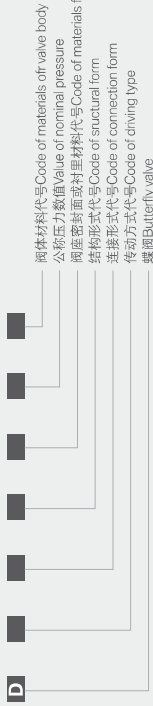

传动方式代号 Code of driving type

传动方式 Driving type	代号 Code	传动方式 Driving type	代号 Code
电磁驱动 Electromagnetic drive	0	伞齿轮 Bevel gear	5
电磁驱动 Electromagnetic and hydraulic	1	气动 Pneumatic	6
电动驱动 Electric and hydraulic	2	液动 Hydraulic	7
蜗轮 Worm wheel	3	气动 Pneumatic and hydraulic	8
正齿轮 Spur gear	4	电动 Electric	9

注: (1) 手柄、手柄和扳手传动以及安全阀、减压阀、液力冲击阀本代号。
(2) 对于气动或液动: 常开式用6K、7K表示; 常闭式用6B、7B表示; 气动带手动GS表示; 防堵电动用9B表示。
Note: (1) For the safety valve, pressure reducing valve and drain valve with hand/wheel handle and wrench driving, the code is omitted.
(2) For pneumatic or hydraulic, the constant open type is expressed in 6K and 7K, the constant close type is expressed in 6B and 7B.
Pneumatic and manual is expressed in 6S, Electric with anti-explosion is expressed in 9B.

连接形式代号 Code of connection form

连接形式 Connection form	内螺纹 Internal thread	外螺纹 External thread	法兰 Flange	焊接 Welding	对夹 Built clamp	卡箍 Hoop	卡套 Ferrule
代号 Code	1	2	4	6	7	8	9

结构形式代号 Code of structural form

蝶阀结构形式 Structural form of butterfly valve	垂直板式 Vertical board type	三偏心式 Three-eccentric center type	单偏心 Single-eccentric center type
代号 Code	1	3	0

阀座密封面或衬里材料代号 Code of materials for valve seat sealing surface and lining

阀座密封面或衬里材料 Code of materials for butterfly valve	代号 Code	阀座密封面或衬里材料 Code of materials for butterfly valve	代号 Code
铜合金 Copper alloy	T	渗氮钢 Nitriding steel	D
橡胶 Rubber	X	硬合金 Hard alloy	Y
尼龙塑料 Nylon plastic	N	衬胶 Rubber lining	J
氟塑料 Fluorine plastic	F	搪瓷 Porcelain enamel	C
巴氏合金 Babbitt alloy	B	衬铅 Lead lining	Q
合金钢 Alloy steel	H	液氮钢 Boron steel	P

注: 由阀体材料加工的阀座密封面或衬里材料不同时, 用低硬度材料代号表示(即薄壁衬胶)。
Note: The code of materials for valve seat and sealing surface processed directly by the valve body is compressed in "W". If the materials of valve seat and valve disk (if Ribboard) sealing surface are different, it shall be expressed in the code of materials with low hardness (Except the diaphragm valve)

公称压力数值 Value of nominal pressure
按JB/T4-59“管路附件公称压力”, 其工作压力和工作压力“酌定”, 当介质最高温度超过530°C时, 按JB/T4-59第5条的规定, 标注工作压力。
The Value of nominal pressure shall be in accordance with the stipulations in JB/T4-59 "Nominal pressure, Testing pressure and working pressure of pipe accessories". For the Valves used in power station industry, when the maximum temperature of the medium exceeds 530°C, according to the stipulations in Article 5 of JB/T4-59, note the working pressure.

阀体材料代号 Code of materials for valve body

阀体材料 Code of materials for valve body	代号 Code	阀体材料 Code of materials for valve body	代号 Code
灰铸铁 Cast iron	Z	铜合金 Copper alloy	T
可锻铸铁 Malleable cast iron	K	碳钢 Carbon steel	C
球墨铸铁 Ductile iron	Q	Cr5Mo	I
		12CrMoV	V

注: PN≤16kgf/cm²的灰铸铁阀体PN≤25kgf/cm²的碳素钢阀体, 省略本单元。
Note: For the cast iron valve body with PN≤16kgf/cm² and carbon steel valve body with PN≤25kgf/cm², the unit is omitted.

中线蝶阀
CENTER LINE-TYPE
BUTTERFLY VALVE

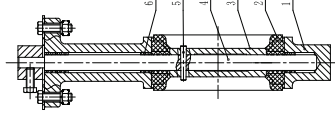

1. 阀体 Body
2. 密封圈 Sealing ring
3. 蝶板 Butterfly board
4. 阀杆 Stem
5. 圆锥销 Straight pin
6. 轴套 Axle sleeve

主要技术参数 Technical specifications for main part 主要零件材料 Material For Main Parts

公称通径 DN (mm)	40~2000	零件名称 Name of Parts	材质 Material
公称压力 PN (MPa)	1.0 1.6	密封圈 Sealing ring	三元乙丙橡胶 EPDM
额定转角 (°)	90	阀体 Body	球墨铸铁 QT450 Nodular cast iron
配用执行机构 Match actuator	手动手轮 wheel 气动活塞式 Pneumatic piston 电动执行器 power-driven actuator	蝶板 Butterfly board	球墨铸铁 QT450 Nodular cast iron
气源压力 (MPa)	0.4~0.6	阀杆 Stem	碳钢 Carbon Steel
电源 (电动) Power source	220V AC 380V AC	O型圈 O-ring	丁腈橡胶 NBR Nitrile rubber
输入信号 Input signal	4~20mA 0~10mA 1~5mA DC 或以上 信号分程控制		
工作温度 T (°C)	≤80		
允许泄漏量 Allowable leakage	A级 GB/T13927-2008		

本产品性能指标贯彻 GB/T12238-2008 标准。
Techniques and performance of the valve implement GB/T12238-2008.

特点 CHARACTERISTICS

1. 小型轻便, 容易拆装及维修, 并可任意位置安装。
2. 结构简单, 紧凑, 90°回转启闭迅速。
3. 操作扭矩小, 省力轻巧。
4. 流量特性趋于直线, 调节性能好。
5. 启闭试验次数达数万次, 寿命长。
6. 达到完全密封, 气体试验泄漏量为零。
7. 选择不同零件材质, 可适用多种介质。

1. It has small and light weight, easy disassembly and maintenance and can be installed anywhere.
2. It has simple and compact structure, 90° rotating quickly.
3. Operation torque is small, labor-saving.
4. Flow characteristics tend to a straight line, adjusting good performance.
5. Test the number of open and close as many as tens of thousands of times; long life.
6. Be Completely sealed the gas leakage test of zero.
7. Choice of different Darfs materials can be used for a variety of media.

1501

对夹式中线蝶阀
Wafer Center Line-Type Butterfly Valve



D71X

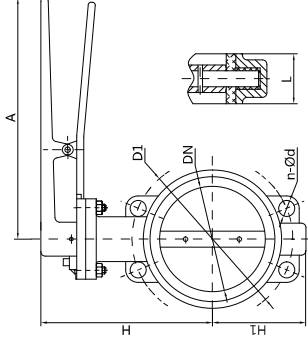

1502

对夹式蜗轮中线蝶阀
Wafer Worm Gear Center Line-Type Butterfly Valve



D371X

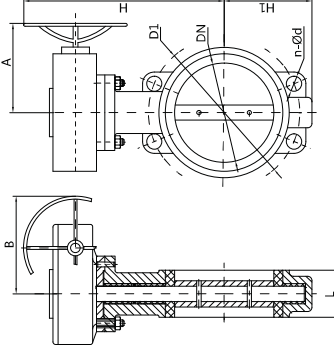

1503

对夹式电动中线蝶阀
Butt-Clamped Electric Rubber-Lined Butterfly Valve

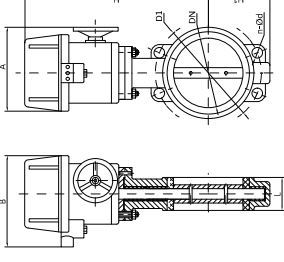

D971X

对夹式气动中线蝶阀
Butt-Clamped Pneumatic Rubber-Lined Butterfly Valve

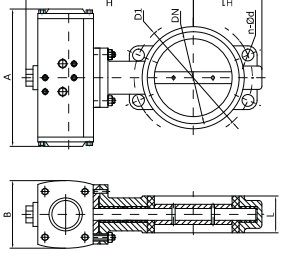

1511

对夹式气动中线蝶阀
Butt-Clamped Pneumatic Rubber-Lined Butterfly Valve

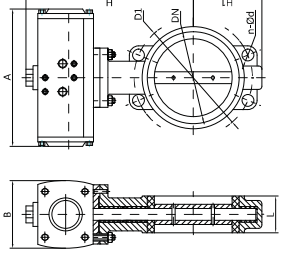

主要外形尺寸 Main External Dimensions

公称通径DN(mm) Nominal diameter	PN16														
	40	50	65	80	100	125	150	200	250	300	350	400	450	500	600
L	41	41	43	43	52	54	54	58	68	78	78	109	114	140	154
D	150	165	185	200	220	250	285	340	405	460	520	580	640	715	840
D1	110	125	145	160	180	210	240	295	355	410	470	525	585	650	770
n-Ød	4-19	4-19	4-19	8-19	8-19	8-19	8-23	12-23	12-28	12-28	16-28	16-31	20-31	20-34	20-37
H1	68	68	76	96	112	125	138	164	206	230	267	310	350	410	450
1511	H	237	248	254	289	323	325	487	556	600	610	620	660	700	800
	A	193	193	193	193	193	193	283	283	334	334	425	425	425	425
	B	125	125	125	125	125	125	165	165	175	175	210	210	210	210
1503	H	352	370	380	390	400	590	610	680	740	780	790	820	860	950
	A	125	125	125	125	125	125	325	325	363	363	363	465	465	546
	B	125	125	125	125	125	245	245	245	373	373	373	413	432	556

注：法兰标准按GB/T17241.6 RF标准制造，也可按用户指定的标准制造，如JIS、ANSI、DIN。
Note: The manufacturer's standard of the external dimensions implement the GB/T17241.6 RF. The standard of JIS, ANSI, DIN are also available by the clients requirement.

附件表 (可选件) Attachment table

1	气动蝶阀 Pneumatic butterfly valve			电动蝶阀 Power-driven butterfly valve		
	电磁阀 Electric locator	5 空气过滤器 Air filtration decompressor	手轮 handwheel	1 电子操作器 Electric operator	4 力矩开关 Switch working torque	5 手轮 Handwheel
2	位置变送器 Position transmitter	6	手轮 handwheel	2 伺服放大器 Servoamplifier	5	手轮 Handwheel
3	限位开关 Limit switch	7	手轮 handwheel	3 位置变送器 Position transmitter	6	限位开关 Limit switch
4	快速排气阀 Rapid escape valve	8	保卫阀 Defend valve			

主要外形尺寸 Main External Dimensions

公称通径DN(mm) Nominal diameter	PN10/16									
	50	65	80	100	125	150				
L	45	45	50	55	58	58				
D1	125	145	160	180	210	240				
n-Ød	4-19	4-19	8-19	8-19	8-23	8-23				
H	1501	147	165	172	195	204				
	1502	147	165	172	195	204				
A	1501	68	76	96	112	138				
	1502	250	250	250	280	280				
B	1501	160	160	160	160	160				
	1502	200	200	200	200	200				

注：法兰标准按GB/T17241.6 RF标准制造，也可按用户指定的标准制造，如JIS、ANSI、DIN。
Note: The manufacturer's standard of the external dimensions implement the GB/T17241.6 RF. The standard of JIS, ANSI, DIN are also available by the clients requirement.

1512

法兰式蜗轮中线蝶阀
Stretch Type Turbine Flange Butterfly valve

D341X

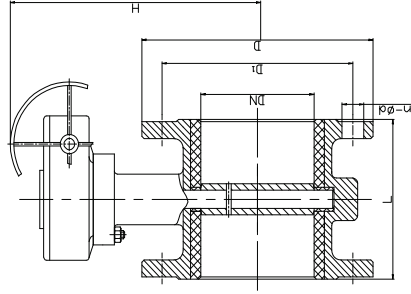

主要外形尺寸 Main External Dimensions

公称通径DN(mm) Nominal diameter	50	65	80	100	125	150	200	250	300	350	400
L	150	170	180	190	200	210	230	250	270	290	310
D	165	185	200	220	250	285	340	405	460	520	580
D1	125	145	160	180	210	240	295	355	410	470	525
n-φd	4-19	4-19	8-19	8-19	8-19	8-23	12-23	12-28	12-28	16-28	16-31
H	230	240	245	260	285	325	440	540	590	675	700
A	160	160	160	160	160	160	210	210	210	210	320

PN16

1513

法兰式蜗轮偏心蝶阀
Eccentric Flanged Butterfly Valve

D340X

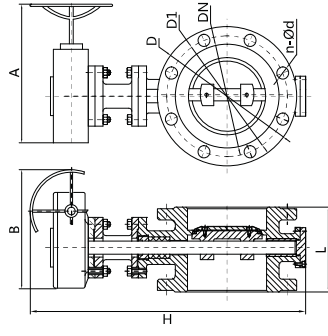

主要外形尺寸 Main External Dimensions

公称通径DN(mm) Nominal diameter	50	65	80	100	125	150	200	250	300	350	400	450
L	108	112	114	127	1400	140	152	165	178	190	216	222
H1	83	93	95	106	125	130	160	190	220	265	275	320
H2	165	180	190	205	280	300	345	400	445	475	530	555
D	165	185	195	215	245	280	335	390	440	500	565	615
D1	125	145	160	180	210	240	295	350	400	460	515	565
b	20	20	22	24	26	26	28	28	28	30	32	32
Z-φd	4-19	4-19	8-19	8-19	8-19	8-23	8-23	12-23	12-23	16-23	16-28	20-28
D	165	185	200	220	250	285	340	405	460	520	580	640
D1	125	145	160	180	210	240	295	355	410	470	525	585
D2	20	20	22	24	26	26	30	32	32	36	38	40
Z-φd	4-19	4-19	8-19	8-19	8-23	8-23	12-23	12-28	12-28	16-28	16-31	20-31

PN16

公称通径DN(mm) Nominal diameter	500	600	700	800	900	1000	1200	1400	1600	1800	2000
L	229	267	292	318	330	410	470	530	600	670	760
H1	340	390	550	580	640	740	850	950	1085	1200	1300
H2	605	700	850	915	1015	1050	1155	1560	1595	1770	1745
D	670	780	895	1015	1115	1230	1455	1675	1915	2115	2325
D1	620	725	840	950	1050	1160	1380	1590	1820	2020	2230
b	34	36	40	44	46	50	56	62	68	70	74
Z-φd	20-28	20-31	24-31	24-34	28-34	28-37	32-40	36-43	40-49	44-49	48-49
D	715	840	910	1025	1125	1255	1485	1685	1930	2130	2345
D1	650	770	840	950	1050	1170	1390	1590	1820	2020	2230
D2	42	48	54	58	62	66	72	78	84	90	98
n-φd	20-34	20-37	24-37	24-40	28-40	28-43	32-49	36-49	40-56	44-56	48-62

注：法兰标准按GB/T17241.6 RF标准制造，也可按用户指定的标准制造，如JIS、ANSI、DIN。
Note: The manufacturer's standard of the external dimensions implement the GB/T17241.6 RF. The standard of JIS, ANSI, DIN are also available by the clients requirement.

注：法兰标准按GB/T17241.6 RF标准制造，也可按用户指定的标准制造，如JIS、ANSI、DIN。
Note: The manufacturer's standard of the external dimensions implement the GB/T17241.6 RF. The standard of JIS, ANSI, DIN are also available by the clients requirement.

3501

法兰式蜗轮三偏心蝶阀
Flange Type Worm Wheel-D
Riven Three-Eccentric Center
Butterfly Valve

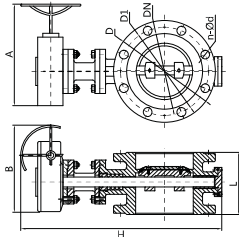

3502

法兰式气动三偏心蝶阀
Flange Type Pneumatic
Three-Eccentric Center Butterfly Valve

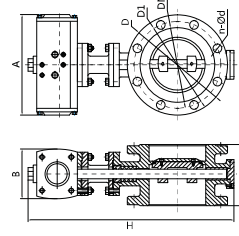

3503

法兰式电动三偏心蝶阀
Flange Type Electric Three-
Eccentric Center Butterfly Valve

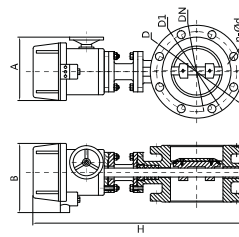

3504

对夹式蜗轮三偏心蝶阀
Butt-clamped worm wheel-driven
three-eccentric center butterfly valve

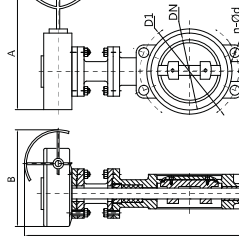

主要外形尺寸 Main External Dimensions

公称通径 DN(mm) Nominal diameter	50	65	80	100	125	150	200	250	300	350	400	450	500	600	700	800
对夹式 法兰式 L	43	46	49	56	64	70	71	76	83	92	102	114	127	154	165	190
D	108	112	114	127	140	140	152	165	178	190	216	222	229	207	292	318
D1	165	185	200	220	250	285	340	405	460	520	580	640	715	840	910	1025
n-Ød	125	145	160	180	210	240	295	355	410	470	525	585	650	770	840	950
H	4-19	4-19	8-19	8-19	8-23	12-23	12-28	12-28	16-31	16-31	20-31	20-34	20-37	24-37	24-40	
3501	350	370	380	420	460	555	760	830	895	950	1190	1255	1255	1305	1520	1710
A	180	180	180	180	270	400	400	450	450	535	535	535	535	570	750	750
B	200	200	200	200	280	425	425	560	560	560	580	580	660	550	550	550
H	625	625	645	675	715	800	850	925	1035	1070	1190	1250	1290	1455	1585	1700
3502	A	245	245	355	355	355	250	250	450	450	450	650	650	850	850	1250
B	72	72	92	92	92	170	220	220	220	220	280	280	280	380	380	380
H	530	530	565	600	640	705	775	945	1070	1140	1210	1335	1415	1605	1844	2040
3503	A	250	250	250	250	300	300	300	300	300	300	300	300	300	300	300
B	255	255	255	255	255	315	315	315	315	315	315	315	315	315	315	315
H	270	290	355	425	460	503	616	690	830	940	975	1040	1105	1370	1525	1670
3504	A	200	200	200	220	220	220	220	260	260	260	260	260	260	260	260
B	130	130	130	130	155	155	155	155	155	155	155	155	155	155	155	155

注：法兰标准按GB/T9113 RF标准制造，也可按用户指定的标准制造，如JIS、ANSI、DIN。
Note: The manufacturer's standard of the external dimensions implement the GB/T9113 RF. The standard of JIS, ANSI, DIN are also available by the clients requirement.

1591

消防蝶阀 (对夹手柄) ZSDF7-Q-16
Fire Protection Butterfly Valve Clip On

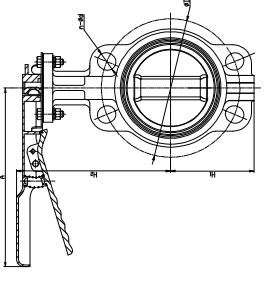
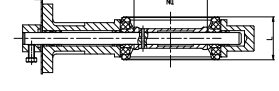

1592

消防蝶阀 (对夹蜗轮) ZSDF7-Q-16-W
Fire Protection Butterfly Valve Gear Type Clip On

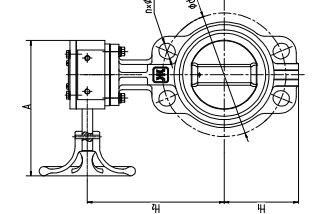
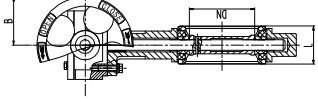

主要外形尺寸 Main External Dimensions

公称通径DN(mm)	50	65	80	100	125	150	200
L	43	46	46	52	56	56	65
D1	125	145	160	186	216	240	295
n-Ød	4-19	4-19	8-19	8-19	8-19	8-23	8-23
H	170	180	190	205	220	235	360
1591	230	235	240	285	310	315	410
1592	70	80	95	115	125	140	185
H1	210	210	210	260	260	260	350
A	110	110	110	120	120	120	190
1591	115	115	115	135	135	135	195
1592	110	110	110	120	120	120	190
B	115	115	115	135	135	135	195

注：产品设计标准：GB5135.6标准制造，也可按用户指定的标准制造，如JIS、ANSI、DIN。
Note: The manufacturer's standard of the external dimensions implement the GB5135.6 RF. The standard of JIS, ANSI, DIN are also available by the clients requirement.

1594

消防蝶阀 (沟槽手柄) ZSDF8-Q-16
Protection Butterfly Valve Grooved

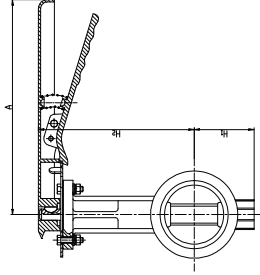
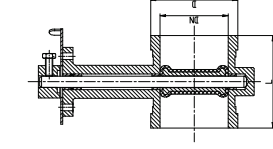

1595

消防蝶阀 (沟槽蜗轮) ZSDF8-Q-16-W
Fire Protection Butterfly Valve Gear Type Grooved

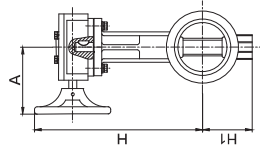
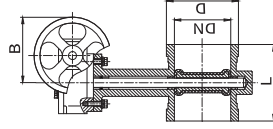

主要外形尺寸 Main External Dimensions

公称通径DN(mm) Nominal diameter	50	65	80	100	150	200
L	80	104	104	120	150	188
D	60.3	76.1	88.9	114.3	165.1	219.6
H	1594	135	145	180	215	290
	1595	215	220	250	270	370
H1	45	52	67	83	112	150
A	1594	210	210	265	265	350
	1595	140	150	150	150	200
B	100	100	110	110	110	190

注：产品设计标准：GB5135.6标准制造，也可按用户指定的标准制造，如JIS、ANSI、DIN。

Note: The manufacturer's standard of the external dimensions implement the GB5135.6. RF. The standard of JIS, ANSI, DIN are also available by the clients requirement.

1593

消防信号蝶阀 (对夹信号) ZSXDF7-Q-16
Fire Signal Butterfly Valve Clip on

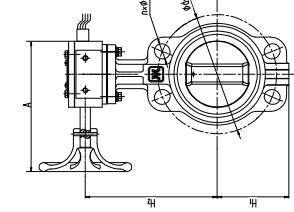
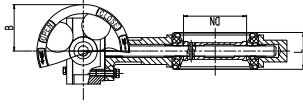

1596

消防信号蝶阀 (沟槽信号) ZSXDF8-Q-16
Fire Signal Butterfly valve Grooved

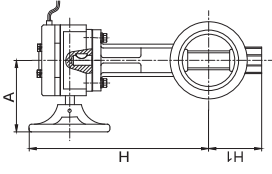
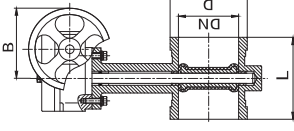

主要外形尺寸 Main External Dimensions

公称通径DN(mm) Nominal diameter	50	65	80	100	125	150	200
L	1593	43	46	52	56	56	56
	1596	80	104	120	120	150	188
D	60.3	76.1	88.9	114.3	140	165.1	219.6
D1	125	145	160	186	216	240	295
n-φd	4-19	4-19	8-19	8-19	8-19	8-23	8-23
H	1593	230	235	280	310	320	410
	1596	215	220	250	250	270	370
H1	1593	70	80	95	115	140	185
	1596	45	52	67	83	112	150
A	1593	110	110	120	135	135	190
	1596	140	140	150	150	150	200
B	1593	115	115	115	135	135	195
	1596	100	100	110	110	110	190

注：产品设计标准：GB5135.6标准制造，也可按用户指定的标准制造，如JIS、ANSI、DIN。

Note: The manufacturer's standard of the external dimensions implement the GB5135.6. RF. The standard of JIS, ANSI, DIN are also available by the clients requirement.

止回阀型号编制方法 (JB/T308-2004)
ESTABLISHMENT METHOD OF CHECK VALVE MODEL

止回阀型号由七个单元组成按下列顺序编制
The valve model is composed of seven units and is established according to the following sequence

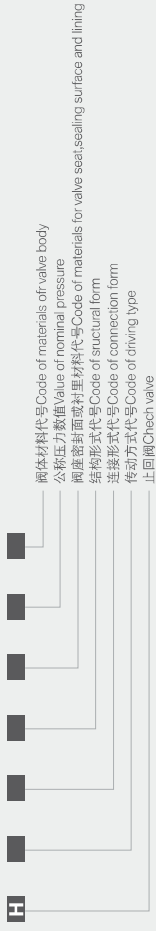

传动方式 Code of driving type

传动方式 Driving type	代号 Code	传动方式 Driving type	代号 Code
电磁驱动 Electromagnetic drive	0	伞齿轮 Bevel gear	5
气动驱动 Pneumatic and hydraulic	1	气动 Pneumatic	6
电动驱动 Electric and hydraulic	2	液压 Hydraulic	7
蜗轮 Worm wheel	3	气动/液压 Pneumatic and hydraulic	8
正齿轮 Spur gear	4	电动 Electric	9

注: (1)手轮、手柄和扳手传动以及安全阀、减压阀、泄水阀等除外。
(2)对于气动驱动: 若为气源驱动, 7B表示; 气动带手动RS表示; 防堵电动用BS表示。
Note: (1) For the safety Valve, pressure reducing Valve and drainage Valve with handwheel handle and wrench driving, the code is omitted.
(2) For pneumatic or hydraulic, the constant open type is expressed in 6K and 7K. The constant close type is expressed in 6B and 7B.

Pneumatic and manual is expressed in 6K and 7K. The constant close type is expressed in 6B and 7B.

连接形式 Code of connection form

连接形式 Connection form	代号 Code	法兰 Flange	焊接 Welding	对夹 Bolt clamp	卡箍 Hoop	卡套 Ferrule
内螺纹 Internal thread	1	2	3	4	5	6
外螺纹 External thread	2	3	4	5	6	7
法兰 Flange	3	4	5	6	7	8
焊接 Welding	4	5	6	7	8	9
对夹 Bolt clamp	5	6	7	8	9	
卡箍 Hoop	6	7	8	9		
卡套 Ferrule	7	8	9			

结构形式 Code of structural form

结构形式 Code of structural form	代号 Code	升降立式 Internal thread	升降立式 Internal thread	升降立式 Internal thread	升降立式 Internal thread	升降立式 Internal thread
直通升降式 Internal thread	1	2	3	4	5	6
升降立式 Internal thread	2	3	4	5	6	
升降立式 Internal thread	3	4	5	6		
升降立式 Internal thread	4	5	6			
升降立式 Internal thread	5	6				
升降立式 Internal thread	6					

阀座密封面或衬里材料 Code of materials for valve seat, sealing surface and lining

阀座密封面或衬里材料 Code of materials for valve seat, sealing surface and lining	代号 Code	阀座密封面或衬里材料 Code of materials for butterfly valve	代号 Code
阀座密封面或衬里材料 Code of materials for butterfly valve		阀座密封面或衬里材料 Code of materials for butterfly valve	
铜合金 Copper alloy	T	渗氮钢 Nitriding steel	D
橡胶 Rubber	X	硬铝合金 Hard alloy	Y
尼龙塑料 Nylon plastic	N	衬胶 Rubber lining	J
氟塑料 Fluorine plastic	F	搪瓷 Porcelain enamel	C
巴氏合金 Babbitt alloy	B	衬铅 Lead lining	Q
合金钢 Alloy steel	H	渗硼钢 Boron steel	P

注: 由阀体直接加工而成的密封面材料代号为“W”表示; 当阀座和阀瓣密封面材料不同时, 用低硬度材料代号表示(隔瓣除外)。
Note: The code of materials for valve seat and sealing surface processed directly by the valve body is expressed in "W". If the materials of valve seat and valve check(Fishboard) sealing surface are different, it shall be expressed in the code of materials with low hardness (Except the diaphragm valve)

公称压力 nominal pressure
按 JB/T459 密封材料公称压力, 当公称压力小于 1.6MPa 时, 按 JB/T459 第 5 条的规定, 标注工作压力。
The Value of nominal pressure shall be in accordance with the stipulations in JB/T459 "Nominal pressure, testing pressure and working pressure of pipe accessories". For the Valves used in power station industry, when the maximum temperature of the medium exceeds 530°C, according to the stipulations in Article 5.01, JB/T459, note the working pressure.

阀体材料 Code of materials for valve body

阀体材料 Code of materials for valve body	代号 Code	阀体材料 Code of materials for valve body	代号 Code
阀体材料 Code of materials for valve body		阀体材料 Code of materials for valve body	
灰铸铁 Cast iron	Z	铜合金 Copper alloy	T
可锻铸铁 Malleable cast iron	K	碳钢 Carbon steel	C
球墨铸铁 Ductile iron	Q	奥氏体不锈钢 Austenitic stainless steel	A
		12Cr1Ni2Mo2Ti	R
		12Cr1MoV	V

注: PN≤16kgf/cm²的灰铸铁阀体PN≥25kgf/cm²的碳钢阀体, 省略本单元。
Note: For the cast iron valve body with 16kgf/cm² and carbon steel valve body with 25kgf/cm², the unit is omitted.

产品结构特点
PRODUCTS DESIGN FEATURES

止回阀适用于压力PN1.6~16.0MPa(Class150~2500), 工作温度-196~600°C的石油、化工、制药、化肥、电力行业等各种工况的管路上。防止介质的倒流。
Check valves are used in pipes under pressure between PN1.6~16.0MPa(Class150~2500), working temperature -196~600°C. They are used in industries include oil, chemistry, pharmaceutical, fertilizer, and power generation to prevent the backward flux of the media.

其主要结构特点有:
The main structure features include:

产品结构合理、密封可靠、性能优良、造型美观。
The products feature a reasonable structure, reliable seal, good performance and nice modeling.

产品可根据不同的工况选择软质密封或硬质密封, 密封面堆焊Co基硬质合金, 耐磨、耐蚀、抗擦伤性能更好, 使用寿命长。
Either soft or hard seal can be selected for the product upon different working conditions. The sealing face is built up with Co-based carbide alloy, leaving a better wearability, corrosion and scrap resistance and a longer duration.

升启压力小, 阀瓣在很小的压差下就能完全打开。
Small opening pressure, the disc can be opened fully with a very small pressure differential.

内装式的销轴结构, 减小外泄漏点, 使用可靠。
Inside-set bolt-bearing structure reduces leakage and reliable use.

公称压力≥16.0MPa(Class1500)中腔采用自紧式密封结构, 密封性能随压力升高而增强, 保证了密封性能。
PN≥16MPa(class1500), the middle cavity uses a self-tightening sealing structure to have the sealing performance reinforced along with the pressure rise so as to ensure the sealing performance.

零件材料及法兰、对焊端尺寸可根据实际工况或用户要求合理选配, 满足各种工程需要。
Different parts materials and flange and butt-welding are available for sensible combination according to different working factors and customer's requirements.

主要技术参数 Main Technical Specifications

基本型号 Serial models	H44H(Y), H64H(Y), H41H(Y), H61H(Y), H42H(Y), H62H(Y), H74H(Y), H71H(Y), H76H(Y), H72H(Y)
压力等级范围 Pressure grade range	PN1.6~42.0MPa(Class150~2500)
通径范围 Drift diameter range	DN15~1000mm(1/2"~40")

产品性能规范 Products Performance Specification

压力等级 Pressure	公称压力 (MPa) Nominal pressure(PN)						磅级 (LB) Pound Grade(Class)					
	1.6	2.5	4.0	6.4	10.0	16.0	25.0	150	300	600	900	1500
常压试验压力 (MPa) Testing pressure at constant temperature (MPa)	壳体试验 Shell testing			密封试验 Seal test								
	2.4	3.75	6.0	9.6	15.0	24.0	37.5	3.0	7.5	15.0	22.5	37.5
适用温度 Applicable temperature	-196~600°C											
适用介质 Applicable medium	水、油品、蒸汽等 Water/oil/steam, ect											

1401

消声止回阀
Muffler Check Valve

H41X

主要零件材料 Material For Main Parts

序号NO.	零件名称 Name of Parts	材质 Material
1	阀体 Body	球墨铸铁QT450 Nodular cast iron
2	阀瓣 Valve clack	三元乙丙橡胶 EPDM
3	密封圈 Sealing ring	三元乙丙橡胶 EPDM
4	阀杆 Stem	球墨铸铁QT450 Nodular cast iron

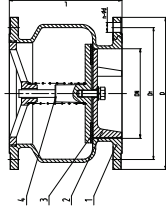

主要外形尺寸 Main External Dimesions

公称通径DN(mm) Nominal diameter	50	65	80	100	125	150	200	250	300
L	118	130	150	162	190	207	253	278	310
D	165	185	200	220	250	285	340	405	460
D1	125	145	160	180	210	240	295	355	410
n-φd	4-19	4-19	8-19	8-19	8-19	8-23	12-23	12-28	12-28

注：法兰标准按GB/T17241.6 RF标准制造，也可按用户指定的标准制造，如JIS、ANSI、DIN。
Note: The manufacturer's standard of the external dimensions implement the GB/T17241.6 RF. The standard of JIS、ANSI、DIN are also available by the clients requirement.

1403

橡胶瓣止回阀
Rubber Flap Check Valve

H44X

主要零件材料 Material For Main Parts

序号NO.	零件名称 Name of Parts	材质 Material
1	阀体 Body	球墨铸铁QT450 Nodular cast iron
2	阀瓣 Valve clack	钢+丁腈橡胶NBR Steel and Nitrile rubber
3	阀盖 Cap	球墨铸铁QT450 Nodular cast iron

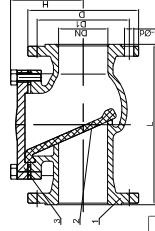

主要外形尺寸 Main External Dimesions

公称通径DN(mm) Nominal diameter	50	65	80	100	125	150	200	250	300
L	203	216	241	292	330	356	492	620	695
D	165	185	200	220	250	285	340	405	460
D1	125	145	160	180	210	240	295	355	410
n-φd	4-19	4-19	8-19	8-19	8-19	8-23	12-23	12-28	12-28

注：法兰标准按GB/T17241.6 RF标准制造，也可按用户指定的标准制造，如JIS、ANSI、DIN。
Note: The manufacturer's standard of the external dimensions implement the GB/T17241.6 RF. The standard of JIS、ANSI、DIN are also available by the clients requirement.

1406

球型止回阀
Sliding Roller Type Check Valve

HQ41X

主要零件材料 Material For Main Parts

序号NO.	零件名称 Name of Parts	材质 Material
1	阀体 Body	球墨铸铁QT450 Nodular cast iron
2	浮球 Ball	不锈钢20+丁腈橡胶NBR SS and Nitrile rubber
3	阀盖 Cap	球墨铸铁QT450 Nodular cast iron

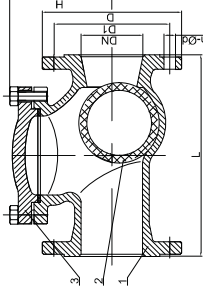

主要外形尺寸 Main External Dimesions

公称通径DN(mm) Nominal diameter	50	65	80	100	150
L	200	225	245	265	350
D	165	185	200	220	285
D1	125	145	160	180	240
n-φd	4-19	4-19	8-19	8-19	8-23

注：法兰标准按GB/T17241.6 RF标准制造，也可按用户指定的标准制造，如JIS、ANSI、DIN。
Note: The manufacturer's standard of the external dimensions implement the GB/T17241.6 RF. The standard of JIS、ANSI、DIN are also available by the clients requirement.

3401

旋启式止回阀
Swing Check Valve

H44H

主要零件材料 Material For Main Parts

序号NO.	零件名称 Name of Parts	材质 Material
1	阀体 Body	铸钢WCB Carbon steel WCB
2	阀瓣 Valve clack	铸钢WCB Carbon steel WCB
3	摇杆 Rocker	不锈钢20Cr13 Stainless steel
4	阀盖 Cap	铸钢WCB Carbon steel WCB

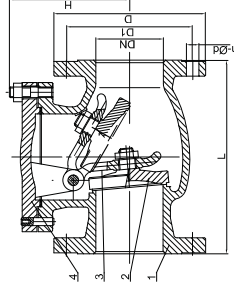

主要外形尺寸 Main External Dimesions

公称通径DN(mm) Nominal diameter	50	65	80	100	150	200
L	230	290	310	350	480	600
D	165	185	200	220	285	340
D1	125	145	160	180	240	295
n-φd	4-18	8-18	8-18	8-18	8-22	12-22
H	165	180	190	208	270	295

注：法兰标准按GB/T19124.1 RF标准制造，也可按用户指定的标准制造，如JIS、ANSI、DIN。
Note: The manufacturer's standard of the external dimensions implement the GB/T19124.1RF. The standard of JIS、ANSI、DIN are also available by the clients requirement.

水力控制阀
HYDRAULIC CONTROL VALVES

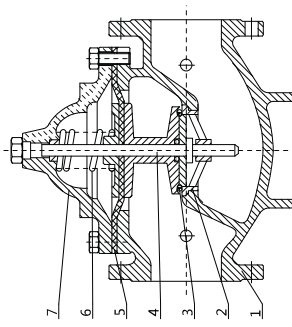

主要零件材料 Material For Main Parts

序号NO.	零件名称/Name of Parts	材质/Material
1	阀体Body	球墨铸铁QT450 铸钢ZG280-520 铸不锈钢GDCr18Ni9
2	阀座Seat	铜合金 铜合金 铸铜OCr18Ni9 不锈钢
3	O型圈O-ring	丁腈橡胶NBR Nitrile rubber
4	阀杆Stem	不锈钢Cr13、0Cr18Ni9 Stainless steel
5	膜片Diaphragm	丁腈尼龙强化橡胶NBR 三元乙丙尼龙强化橡胶EPDM
6	弹簧Spring	弹簧钢Spring steel
7	阀盖Bonnet	球墨铸铁QT450 铸钢ZG280-520 铸不锈钢GDCr18Ni9

结构和工作原理
Structure and work elements

水力控制阀就是用水压控制阀门，一般分为隔膜型和活塞型两大类，两者工作原理相同，它由一个主阀（如图1所示）及其附设的导管、导阀针阀、球阀和压力表等组成。根据使用目的，功能及场所的不同可演变成遥控浮球阀、减压阀、缓闭止回阀、流量控制阀、泄压阀、水力电动控制阀等。水力控制阀都是以上下游压力差AP为动力，由导阀控制，使隔膜（活塞）液压力差自动调节，从而使主阀隔膜完全打开，或完全关闭及处于调节状态，当进入隔膜（活塞）上方控制室的压力水被排到大气或下游低压区时，作用在隔膜下方的压力值就大于上方的压力值，所以将主阀隔膜推至完全开启的位置；当进入隔膜（活塞）上方控制室的压力水不能排到大气或下游低压区时，作用在隔膜（活塞）上方的压力值就大于下方的压力值，所以就会使主阀隔膜压到完全关闭的位置；当隔膜（活塞）上方控制室内的压力值处于入口压力与出口压力中间时，主阀隔膜处于调节状态，其调节位置取决于导管系统中的针阀和可调节阀的联合控制作用。可调节阀可以通过下游的出口压力并随它的变化而开大或关小其自身的小阀口，从而改变隔膜（活塞）上方控制室的压力值，控制主阀隔膜的调节位置。

产品特点
Features

- 具有缓开功能，可避免传统的人关阀开泵；
- 具有缓闭功能，可人为调节关闭时间，自动实现缓闭，消除水锤；
- 具有良好的密封性能，关闭后可达到滴水不漏；
- 动作灵敏、安全可靠，不会出现失控现象；
- 无须人为操作，在管网运行的全过程中均为自动工作；
- 阀内外及所有易腐部件均采用环氧树脂防腐涂层；
- 可拆卸阀座结构巧妙，维修更换方便（无须整台阀门拆除）；
- 在管路上可任意立式或卧式安装其可靠性不变。

1601

遥控浮球阀
Remote Control Float Ball Valve

100X

产品概述

100X遥控浮球阀是兼具多种功能的水力操作式阀门，主要安装在水池溢流管末端溢流管的水位入口处，当水位达到设定的高度时，主阀由浮球导阀控制关闭溢流管出口停止供水。当水位下降后，主阀由浮球开关在打开进水口水池注水，实现自动补水。液位控制精确，不受水压干扰。100X隔膜式遥控浮球阀可随水池的高度及使用情况任意位置安装，维护、调试、检查方便，使用寿命长，使用寿命长。隔膜式阀门性能可靠，强度高，动作灵活适用于450mm口径以下的管道。DN500mm口径以上的建议使用活塞式。

Specification

100X remote control float ball valve is multi-function hydraulic operated valve, installed in the inlet of the pool or elevated water tower. When the water level reaches the inlet height, the main valve controlled by the float guide valve will close the inlet; when drawdown, the valve will replenish water automatically by float valve opening the inlet. Precise liquid level control without water pressure influence, enable the 100X diaphragm type remote control float ball valve can be installed anywhere according to the pool height and space. It also enjoys the advantage of convenient maintenance, debugging, checking, reliable sealing and quality. The diaphragm type valve, with reliable performance, high strength, flexible movement, is suitable to be mounted on maximum DN450 pipelines. Over DN500 pipelines are suitable to the piston type.

主要技术参数 Technical specifications for main part

公称口径DN (mm) Nominal diameter	40~450
公称压力PN (MPa) Nominal pressure	1.6
工作温度T (°C) Working temperature	0~80
允许泄漏量 Allowable leakage	A级 GB/T13927-2008
液面控制精度 (mm) The precision of liquid level control	±30

- 1.浮球导阀
Float Guide Valve
- 2.球阀
Ball Valve
- 3.针形阀
Needle Valve

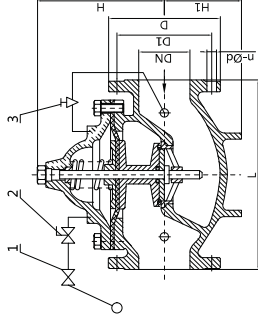

典型安装示意图
Typical Installation Diagram

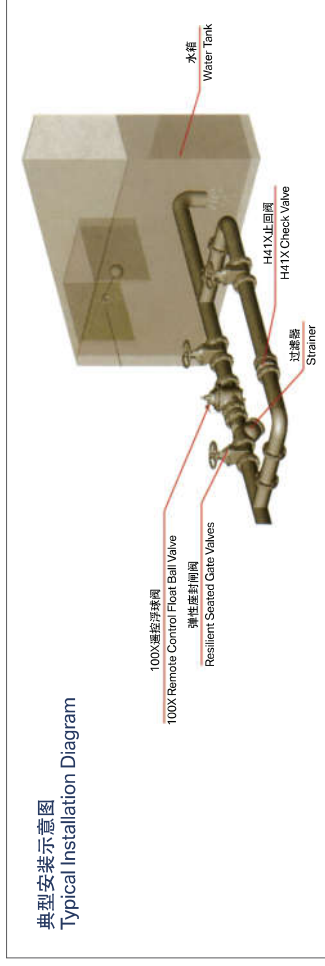

主要连接外形尺寸 Main Connection Dimensions

公称口径 DN(mm) Nominal diameter	40	50	65	80	100	125	150	200	250	300	350	400	450
L	203	203	213	240	292	325	355	455	458	607	645	720	720
D	150	165	185	200	220	250	285	340	405	460	520	580	640
D1	110	125	145	160	180	210	240	295	355	410	470	525	585
n-d	4-19	4-19	4-19	8-19	8-19	8-23	12-23	12-28	12-28	16-31	16-31	20-31	20-31
H	220	220	265	265	300	340	370	460	500	640	660	950	1000
H1	130	130	170	170	180	220	270	290	320	325	325	750	800

注：法兰标准按GB/T17241.6 RF标准制造，也可按用户指定的标准制造，如JIS、ANSI、DIN。
Note: The manufacturer's standard of the external dimensions implement the GB/T17241.6 RF. The standard of JIS, ANSI, DIN are also available by the clients requirement.



1602

减压稳压阀
Pressure Reducing Valve

200X

产品概述

200X减压稳压阀, 是一种利用介质自身能量来调节与控制管路压力的智能型阀门。200X减压阀用于生活给水、消防给水及其他工业给水系统, 通过调节减压导阀, 即可调节主阀的出口压力。出口压力不因进口压力、进口流量的变化而变化, 安全可靠地将出口压力维持在设定值上, 并可根据需要调节设定值以达到减压目的。该阀减压精确, 性能稳定, 安全可靠, 安装调节方便, 使用寿命长。

Specification

200X Pressure Reducing Valve is a smart device using the medium momentum to regulate and control the line pressure. It is used for domestic water supply, fire fighting water supply and other industrial water supply system, regulating the outlet pressure of the main valve by the decompression guide valve. The outlet pressure will not change when the inlet pressure and inlet flow rate changed, maintaining the outlet pressure safely as stated. Also the set point can be adjusted as required. This valve reduces pressure precisely, performs stable, safe and secure, easy installation and has long service life.

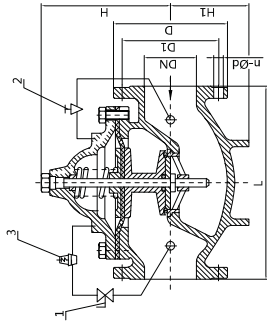

1.球阀 Ball Valve
2.减压导阀 Pressure Reducing Valve
3.针形阀 Needle Valve

主要技术参数 Technincal specifications for main part

公称通径DN (mm) Nominal diameter	40~450	工作温度T (°C) Working temperature	0~80
公称压力PN (MPa) Nominal pressure	1.6	允许泄流量 Allowable leakage	A级 GB/T 13927-2008
最高进口压力P1max (MPa) Max inlet pressure	1.6	最高出口压力P2max (MPa) Max outlet pressure	DN50-DN80 0.1~0.5MPa DN50-DN80 0.1~1.2MPa
最低进口压力P1min (MPa) Min inlet pressure	P2min+0.2	最低出口压力P2min (MPa) Min outlet pressure	0.1

典型安装示意图
Typical Installation Diagram

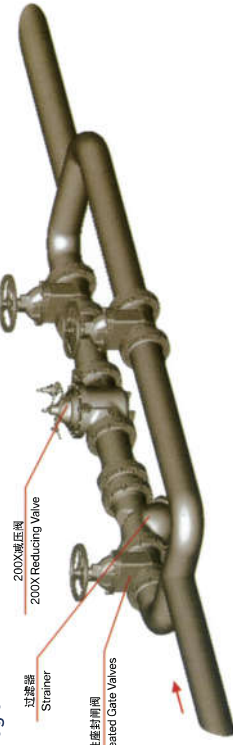

主要连接外形尺寸 Main Connection Dimensions

公称通径 DN(mm) Nominal diameter	40	50	65	80	100	125	150	200	250	300	350	400	450	500
L	203	203	213	240	292	325	355	455	458	607	645	720	720	720
D	150	165	185	200	220	250	285	340	405	460	520	580	640	640
D1	110	125	145	160	180	210	240	295	355	410	470	525	585	585
n-φd	4-19	4-19	4-19	4-19	4-19	4-19	4-19	8-23	12-23	12-28	16-28	16-31	20-31	20-31
H	220	220	220	265	265	300	340	405	460	500	640	860	950	1000
H1	130	130	170	170	180	220	220	380	270	290	320	325	750	800

注: 法兰标准按GB/T17241.6 RF标准制造, 也可按用户指定的标准制造, 如JIS, ANSI, DIN.
Note: The manufacturer's standard of the external dimensions implement the GB/T 17241.6 RF. The standard of JIS, ANSI, DIN are also available by the clients requirement.

1603

缓闭式止回阀
Slow Close Check Valve

300X

产品概述

300X缓闭式止回阀是安装在高层建筑给水系统以及其他给水系统的水泵出口处, 防止介质倒流、水锤及水击现象的智能型阀门。该阀兼具电动阀、截止阀和水锤消除器三种功能, 可有效提高供水系统的安全可靠性, 并具备缓开、速闭、缓闭消除水锤的技术原理一体化, 防止开泵水锤和停泵水锤的产生, 只需操作水泵电机启动按钮, 阀门即可按照水泵操作规程自动实现启闭, 流量大, 压力损失小, 适用于600口径以下的阀门。

Specification

300X Slow Close Check Valve is a smart device mounted in water supply system of high buildings or on the pump outlet to prevent from danger caused by back-flow and water hammer. Combining with the function of electrically operated valve, check valve and water-hammer arrester, this valve can improve safe reliability in water supply system efficiently and remove water hammer when open and close the pump by integrating the technology of slow open, fast close and slow close. Just operating pump opening and closing button, valve can automatically realize on-off operation procedures, large flow with low pressure loss. Slow Close Check Valve is suitable for maximum DN600 valve.

主要技术参数 Technincal specifications for main part

公称通径DN (mm) Nominal diameter	40~450	公称压力PN (MPa) Nominal pressure	1.6
最小关闭压力P1 (MPa) Min closed pressure	≤0.05	工作温度T (°C) Working temperature	0~80
允许泄流量 Allowable leakage	A级 GB/T13927-2008	缓闭时间 (s) Slow closing time	2~60

1.针形阀 Needle Valve
2.止回阀 Check Valve
3.球阀 Ball Valve

典型安装示意图
Typical Installation Diagram

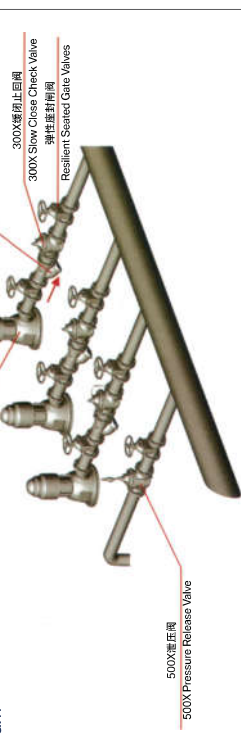

主要连接外形尺寸 Main Connection Dimensions

公称通径 DN(mm) Nominal diameter	40	50	65	80	100	125	150	200	250	300	350	400	450	500
L	203	203	213	240	292	325	355	455	458	607	645	720	720	720
D	150	165	185	200	220	250	285	340	405	460	520	580	640	640
D1	110	125	145	160	180	210	240	295	355	410	470	525	585	585
n-φd	4-19	4-19	4-19	4-19	4-19	4-19	4-19	8-23	12-23	12-28	16-28	16-31	20-31	20-31
H	220	220	220	265	265	300	340	405	460	500	640	860	950	1000

注: 法兰标准按GB/T17241.6 RF标准制造, 也可按用户指定的标准制造, 如JIS, ANSI, DIN.
Note: The manufacturer's standard of the external dimensions implement the GB/T 17241.6 RF. The standard of JIS, ANSI, DIN are also available by the clients requirement.



1605

持压/泄压阀
Pressure Relief Valve

500X

产品概述

500X持压阀主要用于消防或其它供水系统中，以防止系统超压。消防泵关闭后还可以减小水锤的冲击。系统动作平稳、强度高、使用寿命长。适用于600口径以下的管道。

Specification

500X pressure release valve mainly used in fire fighting or other water supply systems to prevent from overpressure. When closed, it can reduce the impact of water hammer. Also, it enjoys the advantage of smooth action, high intensity and reliably quality. This valve is suitable for pipeline maximum DN600.

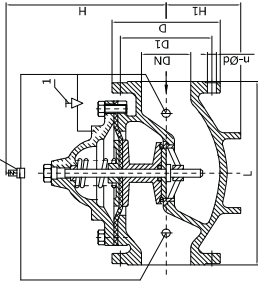

1. 针形阀 Needle Valve

主要技术参数 Techniacal specifications for main part

公称通径DN (mm) Nominal diameter	40~450
公称压力PN (MPa) Nominal pressure	1.6
整定压力P1 (MPa) Set pressure	≤1.33
工作温度T (°C) Working temperature	0~80
允许泄漏量 Allowable leakage	A级 GB/T13927-2008

2. 泄压阀 Pressure Relief Valve

典型安装示意图
Typical Installation Diagram

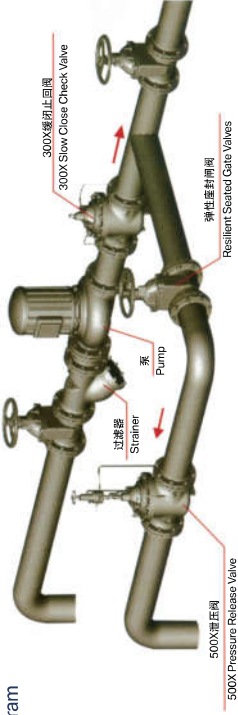

主要连接外形尺寸 Main Connection Dimensions

公称通径 DN (mm) Nominal diameter	40	50	65	80	100	125	150	200	250	300	350	400	450
L	203	203	213	240	292	325	355	455	458	607	645	720	720
D	150	165	185	200	220	250	285	340	405	460	520	580	640
D1	110	125	145	160	180	210	240	295	355	410	470	525	585
n-Ød	4-19	4-19	4-19	8-19	8-19	8-23	12-23	12-23	12-28	16-28	16-31	20-31	20-31
H1	170	170	310	310	320	360	360	410	430	460	465	750	800
H	360	360	405	405	440	480	510	600	640	780	900	950	1000

注：法兰标准按GB/T17241.6、PF标准制造，也可按用户指定的标准制造。如JIS、ANSI、DIN。
Note: The manufacturer's standard of the external dimensions implement the GB/T17241.6 PF. The standard of JIS, ANSI, DIN are also available by the clients requirement.



1609

多功能水泵控制阀
Multifunctional Water Pump Control Valve

JD745X

产品概述

多功能水泵控制阀安装在高层建筑给水系统以及其他供水系统的水泵出口处，防止介质倒流、水锤及水击引发的倒流和阀门。该阀兼具有动阀、止回阀和水锤消除器三种功能，可有效地提高供水系统的安全性。只需将阀打开，消除水锤的技术原理一体化，防止开泵水锤和停泵水锤的产生。只需操作水泵电机启动按钮，阀门即可按照水泵操作程序自动实现启闭，流量大，压力大，压力损失小。

Specification

Multifunctional water pump control valve is a smart valve, which is installed in the outlets of high-rise building water supply systems and other water supply systems. It has the function of preventing media backflow and water hammer phenomenon. The valve has same function as the dynamic valve, check valve and water hammer eliminator. It can effectively improve the safety and reliability of the water supply system. The valve integrate the technical principles of slow opening, quick closing, and elimination of water hammer, to prevent the water hammer phenomenon when open or close the water pump. Simply operate the water pump motor on/off button, the valve can be automatically opened and closed in accordance with the pump operating procedures.

主要技术参数 Techniacal specifications for main part

公称通径DN (mm) Nominal diameter	40~450
公称压力PN (MPa) Nominal pressure	1.6
工作温度T (°C) Working temperature	0~80
允许泄漏量 Allowable leakage	A级 GB/T13927-2008

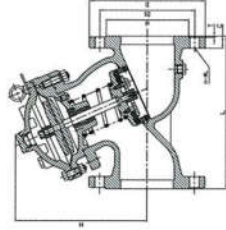

1. 过滤器 2. 小球阀 3. 过滤器 4. 小球阀

典型安装示意图
Typical Installation Diagram

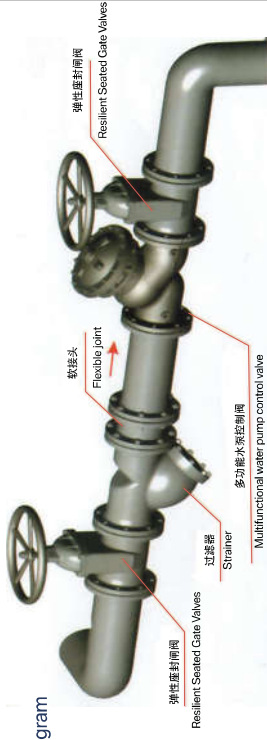

主要连接外形尺寸 Main Connection Dimensions

公称通径 DN (mm) Nominal diameter	40	50	65	80	100	125	150	200	250	300	350	400	450
L	230	230	235	250	285	330	362	435	505	608	645	720	720
D	150	165	185	200	220	250	285	340	405	460	520	580	640
D1	110	125	145	160	180	210	240	295	355	410	470	525	585
n-Ød	4-19	4-19	4-19	8-19	8-19	8-23	12-23	12-28	12-28	16-28	16-31	20-31	20-31
H1	170	170	310	310	320	360	360	410	430	460	465	750	800
H	360	360	405	405	440	480	510	600	640	780	900	950	1000

注：法兰标准按GB/T17241.6、RF标准制造，也可按用户指定的标准制造。如JIS、ANSI、DIN。
Note: The manufacturer's standard of the external dimensions implement the GB/T17241.6 RF. The standard of JIS, ANSI, DIN are also available by the clients requirement.

3301

铸钢截止阀
Cast Steel Stop Valve

J41H



结构特点及用途

截止阀结构简单，密封面积小，节省金属材料；密封面磨损及擦伤较轻，密封性好，使用寿命长，开启高度小，节省安装空间。广泛应用于管路中保护设备，如泵、管道、控制阀门、蒸汽汽水等。适用介质为：水、气、油品等。

Structural Features and Applications

Stop valve has simple structure and little sealing areas, which could reduce the use of precious metals. Sealing surface has little friction, which is better for sealing and long-time using. The low height of opening distance is good for reducing the install space. Widely used in equipment for protection, like pump, pipes, control valve and so on. Work medium: water, gas, oils.

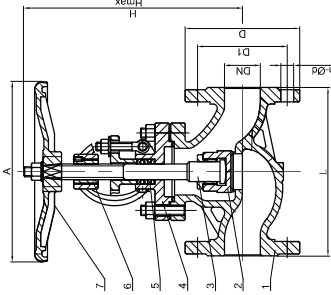

- 1、阀体Body
- 2、阀芯Core
- 3、阀杆Stem
- 4、阀盖Bonnet
- 5、填料Packing
- 6、传动螺母Driving nut
- 7、手轮Handwheel

主要技术参数 Techniacal specifications for main part

公称通径DN (mm) Nominal diameter	10~300
公称压力PN (MPa) Nominal pressure	1.6
工作温度T (°C) Working temperature	-20~200
允许泄漏量 Allowable leakage	GB/T26480

主要零件材料 Material For Main Parts

零件名称 Name of Parts	材质 Material
阀体 Body	铸钢 WCB Carbon steel WCB
阀芯 Core	不锈钢 20Cr13 Stainless steel
阀杆 Stem	不锈钢 20Cr13 Stainless steel
阀盖 Bonnet	铸钢 WCB Carbon steel WCB
填料 Packing	聚四氟乙烯 PTFE

本产品性能指标参照GB/T12235-2007标准。
Techniques and performance of the valve implement GB/T12235-2007.

主要外形尺寸 Main External Dimensions

公称通径 DN(mm) Nominal diameter	PN16														
	10	15	20	25	32	40	50	65	80	100	125	150	200	250	300
L	130	130	150	160	180	200	230	290	310	350	400	480	600	730	850
D	90	95	105	115	140	150	165	185	200	220	250	285	340	405	460
D1	60	65	75	85	100	110	125	145	160	180	210	240	295	355	410
n-φd	4-14	4-14	4-14	4-18	4-18	4-18	4-18	8-18	8-18	8-18	8-18	8-22	12-22	12-26	12-26
H	198	218	258	275	280	330	350	400	355	415	460	510	710	786	925
A	80	80	80	80	90	100	120	200	200	240	240	360	400	500	500

注：法兰标准按GB/T9124.1 RF标准制造，也可按用户指定的标准制造，如JIS、ANSI、DIN。
Note: The manufacturer's standard of the external dimensions implement the GB/T9124.1 RF. The standard of JIS、ANSI、DIN are also available by the clients requirement.

3210

法兰球阀
Flange Type ball valve

Q41F



结构特点及用途

本阀密封阀圈采用优质塑料等软材料，具有可靠地密封性；流通能力大，且流向不受限制；结构简单，维修方便等优点。除适用于一般的气体、液体外，更适用于高粘度、以及带有纤维状和悬浮颗粒的介质。广泛应用于饮用水、给排水、废水、污水处理、建筑、消防、石油、化工、食品、制药、轻纺、电力、冶金、能源系统等流体管线上作为截流装置使用。

Structural Features and Applications

The sealing ring of the valve is made of high quality soft plastic what has better sealing; better liquidity and no limited flow direction; simple structures result in easy maintenance in addition to normal medium, it is more widely used in particles and suspension medium, widely used in drinking water pipes, water supply and drainage, sewage treatment, construction, fire control, petroleum, chemical, food, pharmacy, light textile, electric power, metallurgy, energy system and other industries for regulating flow.

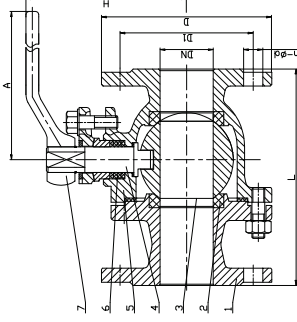

- 1、副阀体Vice body
- 2、密封圈Sealing ring
- 3、球芯Ball
- 4、阀杆Stem
- 5、主阀体Main body
- 6、填料Packing
- 7、手柄Band wheel

主要零件材料 Material For Main Parts

零件名称 Name of Parts	材质 Material
主阀体Main body	铸钢 WCB Carbon steel WCB
副阀体Vice body	铸钢 WCB Carbon steel WCB
密封圈 Sealing ring	聚四氟乙烯 PTFE
阀杆Stem	不锈钢 20Cr13 Stainless steel
填料Packing	聚四氟乙烯 PTFE

主要技术参数 Techniacal specifications for main part

公称通径DN (mm) Nominal diameter	15~100
公称压力PN (MPa) Nominal pressure	1.6
额定转角 (°) Rated corner	90
工作温度T (°C) Working temperature	-20~150
允许泄漏量 Allowable leakage	GB/T26480

本产品性能指标参照GB/T12237-2007标准。
Techniques and performance of the valve implement GB/T12237-2007.

主要外形尺寸 Main External Dimensions

公称通径 DN(mm) Nominal diameter	PN16									
	15	20	25	32	40	50	65	80	100	300
L	108	117	127	140	165	178	190	203	229	229
D	95	105	115	140	150	165	185	200	220	220
D1	65	75	85	100	110	125	145	160	180	180
n-φd	4-14	4-14	4-14	4-18	4-18	4-18	4-18	8-18	8-18	8-18
H	61	63	72	75	102	108	145	185	203	203
A	150	150	180	180	220	220	260	300	300	300

注：法兰标准按GB/T9124.1 RF标准制造，也可按用户指定的标准制造，如JIS、ANSI、DIN。
Note: The manufacturer's standard of the external dimensions implement the GB/T9124.1 RF. The standard of JIS、ANSI、DIN are also available by the clients requirement.

1701

铸铁过滤器
Y Filters

GL41

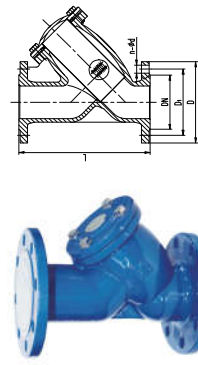

主要技术参数

Techninacal specifications for main part

公称通径DN(mm) Nominal diameter	50~400
公称压力PN (MPa) Nominal pressure	1.6
工作温度T (°C) Working temperature	0~100

主要零件材料 Material For Main Parts

零件名称 Name of Parts	材质 Material
网盖 cap	球墨铸铁QT450 Nodular cast iron
网体 body	球墨铸铁QT450 Nodular cast iron
过滤网filter screen	不锈钢 Stainless steel

主要外形尺寸 Main External Dimensions

公称通径DN(mm) Nominal diameter	50	65	80	100	125	150	200	250	300
L	204	245	273	315	335	365	442	495	565
D	165	180	200	220	250	285	340	405	460
D1	125	145	160	180	210	240	295	355	410
n-φd	4-19	4-19	8-19	8-19	8-23	12-23	12-23	12-28	12-28

注：法兰标准按GB/T17241.6 RF标准制造，也可按用户指定标准制造，如JIS、ANSI、DIN。
Note: The manufacturer's standard of the external dimensions implement the GB/T17241.6 RF. The standard of JIS, ANSI, DIN are also available by the clients requirement.

3606

铸钢过滤器
Cast Steel Strainer

GL41

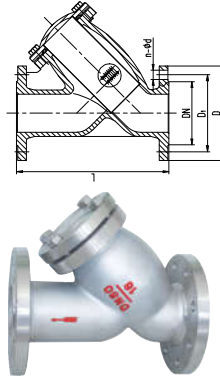

主要技术参数

Techninacal specifications for main part

公称通径DN(mm) Nominal diameter	15~600
公称压力PN (MPa) Nominal pressure	1.6
工作温度T (°C) Working temperature	-20~200

主要零件材料 Material For Main Parts

零件名称 Name of Parts	材质 Material
网盖 cap	铸钢 WCB Carbon steel WCB
网体 body	铸钢 WCB Carbon steel WCB
过滤网filter screen	不锈钢 Stainless steel

主要外形尺寸 Main External Dimensions

公称通径DN(mm) Nominal diameter	15	20	25	32	40	50	65	80	100	125	150	200	250	300	350	400	500	600
L	108	117	127	140	165	203	216	241	290	330	356	457	533	635	780	850	850	1000
D	95	105	115	140	150	165	180	200	220	250	285	340	405	460	520	560	560	715
D1	65	75	85	100	110	125	145	160	180	210	240	295	355	410	470	525	650	770
n-φd	4-14	4-14	4-14	4-18	4-18	4-18	8-18	8-18	8-18	8-18	8-22	12-22	12-26	12-26	16-26	16-30	20-33	20-36

注：法兰标准按GB/T9124.1RF标准制造，也可按用户指定的标准制造，如JIS、ANSI、DIN。
Note: The manufacturer's standard of the external dimensions implement the GB/T9124.1RF. The standard of JIS, ANSI, DIN are also available by the clients requirement.

1705

单口排气阀
Single Opening Air Venting Valve

PIIX

结构特点及用途

在一般情况下，水中约含有2VOL%的溶解空气，在输水过程中，这些空气由水中不断释放出来，聚集在管线的高点处，形成空气袋（AIR POCKET），使输水变得困难，系统输水能力可因此下降5-15%，排气阀的主要功能就是排除这2VOL%的溶解空气，并适合装置于高层建筑，厂区内配管，小型泵站用以保护或改善系统的输水功率及节约能源。

Specification

In general, water contains about 2 VOL% of dissolved air, and in the process of water delivery, the air is continuously released from the water, and collected at the high point of the pipeline to form an air bag (AIR POCKET). This makes it difficult to transport water, and the capacity of the system's water delivery is therefore reduced by 5-15%. Therefore, the main function of the Air Venting Valve is to eliminate the 2VOL% dissolved air, which is suitable for installation in high-rise buildings, factory area piping, small pump station to protect or improve the system's power of transmission and save energy.

主要技术参数 Techninacal specifications for main part

公称通径DN(mm) Nominal diameter	15-50
公称压力PN (MPa) Nominal pressure	1.6
工作温度T (°C) Working temperature	0~100

主要外形尺寸 Main External Dimensions

公称通径DN(mm) Nominal diameter	15(1/2")	20(3/4")	25(1")	32(1-1/4")	40(1-1/2")	50(2")
H	127	127	127	150	150	150

1706

单口排气阀
Single Opening Air Venting Valve

P4IX

结构特点及用途

在一般情况下，水中约含有2VOL%的溶解空气，在输水过程中，这些空气由水中不断释放出来，聚集在管线的高点处，形成空气袋（AIR POCKET），使输水变得困难，系统输水能力可因此下降5-15%，排气阀的主要功能就是排除这2VOL%的溶解空气，并适合装置于高层建筑，厂区内配管，小型泵站用以保护或改善系统的输水功率及节约能源。

Specification

In general, water contains about 2 VOL% of dissolved air, and in the process of water delivery, the air is continuously released from the water, and collected at the high point of the pipeline to form an air bag (AIR POCKET). This makes it difficult to transport water, and the capacity of the system's water delivery is therefore reduced by 5-15%. Therefore, the main function of the Air Venting Valve is to eliminate the 2VOL% dissolved air, which is suitable for installation in high-rise buildings, factory area piping, small pump station to protect or improve the system's power of transmission and save energy.

主要外形尺寸 Main External Dimensions

公称通径DN(mm) Nominal diameter	50	80	100	125	150	200
D	160	195	215	245	280	335
D1	125	160	180	210	240	295
H	280	300	330	360	390	440
n-φd	4-14	4-18	8-18	8-23	8-23	8-23

主要技术参数

Techninacal specifications for main part

公称通径DN(mm) Nominal diameter	15-50
公称压力PN (MPa) Nominal pressure	1.6
工作温度T (°C) Working temperature	0~100

1801

复合式快速排(进)气阀
Composite Quick Exhaust/Inlet Valve

CARX



结构特点及用途

本产品用于管路上的最高点或有阴气的地方和泵浦出口处。来排除管内的气体来疏通管道，使管道达到正常工作。如不装排气阀，管道随时出现气阻，使管道出水容量达不到设计要求。其次：管道在运转时出现停电，停泵管道及时出现负压为引起管道振动或破裂、排、进气阀就迅速把空气吸入管内，防止管道振动或破裂。

复合式排气阀它必须设有二孔一大一小，大孔与通径孔基本相等，管道首次通水有大量气体往外排，这些气体是从大孔排出。当气体排完后，大孔停止排气，管道在正常转动时，管内自然会产生气囊体，这些气体会慢慢形成变大，会集中到管道上部，对管道出水有一定影响，这些气体由小孔解决排除，使管内无气体存在。如出现停泵、停泵、管内水冻结时随时会出现负压。管内需要大量空气，浮球顺水下降，打小孔带动大孔进行大量进气确保管道安全。

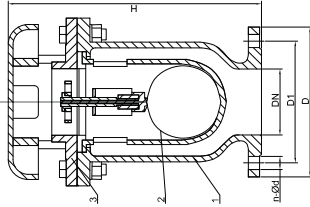

1. 阀体Body
2. 浮球Ball
3. 阀盖Cap

Structural Features and Applications

This product is used at the highest point of pipelines, the place where air is shut off, or the outlets of pumps in order to eliminate air and dredge pipelines. If the vent valve is not set, the air in the pipeline will be possibly shut off at any time, and the water content will not meet the design requirement. If the electricity is suddenly cut off when the pipeline is at work, the negative pressure in the pipeline will cause vibration or cracking. In this case, the vent valve can quickly inhale air into the pipeline and prevent the vibration and cracking of it.

There are two holes in the compound vent valve, one big, one small. The diameter nearly equals DN. The first time water is passed in the pipeline a large amount of air will be released through the big hole. Immediately the air is completely removed, the big hole stops working. When the pipeline is at work, air cells will be generated. And air cells will grow bigger while move to the upper part of the pipeline, which will have a negative influence on the flow of water. At this moment, these air cells can be removed through the small hole. There fore no air can exist in the pipeline. When the electricity is cut off, the pump does not work, or there is no water flow in the pipeline, negative pressure will be generated and there will be a great need of air in the pipeline. In order to inhale a lot of air, a floating ball will fall and open the small hole which will drive the opening of the big hole.

主要零件材料 Material For Main Parts

零件名称 Name of Parts	材质 Material
阀体 Body	球墨铸铁QT450 Nodular cast iron
浮球 Ball	不锈钢OCr18Ni9 Stainless steel
杠杆 Lever	不锈钢OCr18Ni9 Stainless steel

主要技术参数 Technincal specifications for main part

公称通径DN(mm) Nominal diameter	25~150
公称压力PN (MPa)	1.0 1.6
工作压力 Working pressure	0~100
工作温度T (°C)	0~100

主要外形尺寸 Main External Dimesions

公称通径DN(mm) Nominal diameter		PN10									
D	25	50	80	100	150	200	250	300	350	400	
D1	115	160	195	215	280	335	390	440	500	555	
H	85	125	160	180	240	295	350	400	460	515	
n-φd	320	320	375	395	500	600	680	780	860	940	
	4-14	4-18	4-18	8-18	8-23	12-23	12-23	16-23	16-23	16-25	

注：排气阀在使用过程中压力不能低于0.02MPa，如低于0.02MPa排气阀容易漏水，该阀必须配一只阀门作为检修用。

Note: The working pressure of vent valve cannot be over 0.02MPa if not, water will be leaked. And this valve should be equipped with another valve for its maintenance.

1802

复合式排气阀
Composite Exhaust Valve

CARX



结构特点及用途

本阀安装在泵出口处或配水管线中，用来排除聚集在管中的空气，以提高管线及水泵的使用效率。当管内一旦产生负压，此阀迅速吸入外界空气，以防止管线因负压而损坏。当管内开始注水时，阀瓣处于开启的位置，进行大量的排气，当空气排完后，阀内充满水，浮球上升并带动阀瓣关闭，停止排气，当管内水正常输送时，如果少量空气聚集在管内到相当的程度，阀内水位下降，此时空气由小孔排出。当水泵停止时，管内水流空或遇管内产生负压，此时塞头迅速升起，吸入空气，确保管线安全。

Structural Features and Applications

The valve installed at the exit or in the pipe line is used to discharge the air gathering in the pipe to improve the efficiency of system. When the pipe system is in a negative pressure, the valve can quickly suck the air outside to avoid the pipe broken for low pressure. When water begin to go into the pipe, the valve clack will be opened for gas emptying. Until the pipe is full of water, the clack will closed to stop discharging air. when the system is working, A little gas will be drained through the small hole of the valve when the water pump stop working, the space inside pipe is in a negative pressure and the valve will open quickly to keep the inside and outside air balance, which is better for system security.

主要技术参数 Technincal specifications for main part

公称通径DN(mm) Nominal diameter	25~150
公称压力PN (MPa)	1.0 1.6
工作压力 Working pressure	0~100
工作温度T (°C)	0~100

主要零件材料 Material For Main Parts

零件名称 Name of Parts	材质 Material
阀体 Body	球墨铸铁QT450 Nodular cast iron
浮球 Ball	不锈钢OCr18Ni9 Stainless steel
杠杆 Lever	不锈钢OCr18Ni9 Stainless steel

主要外形尺寸 Main External Dimesions

公称通径DN(mm) Nominal diameter		PN16									
D	25	32	40	50	65	80	100	125	150		
螺纹连接C Silk mouth	1	1 1/4	-	-	-	-	-	-	-		
D1	-	-	150	165	180	200	220	250	285		
n-φd	-	-	110	125	145	160	180	210	240		
H	440	440	4-19	4-19	4-19	8-19	8-19	8-19	8-23		
A	290	290	290	345	375	410	415	460	480		

注：法兰标准按GB/T17241.6 RF标准制造，也可按用户指定的标准制造，如JIS、ANSI、DIN。

Note: The manufacturer's standard of the external dimensions implement the GB/T17241.6 RF. The standard of JIS, ANSI, DIN are also available by the clients requirement.



3801

KPF 平衡阀
KPF Balance valve

KPF

概述

本阀是一种具有特殊功能的阀门，具有良好的流量特性，能够合理的分配流量，实现流量平衡，可以有效地解决供热（空调）系统中存在的室温冷热不均问题，由于该阀门没有启闭指示，并采用定流量差压及用差压流量测定的流量小阀，所以在各支路及用户入口装上适当规格的平衡阀，并用专用智能仪表进行一次性调试后锁定，将系统的总水量控制在合理的范围内，从而克服了“大流量，小温差”的不合理化现象。

Overview

Balance valve is a valve of special function, has a good flow characteristic and can reasonably distribute flow and realize the flow ration and effectively settle the problem of uneven cold and hot room temperatures existing in the heat supply/air conditioning system. Because this valve is set with an indicator of opening, an opening locker and a small valve of pressure measurement for flow determination, so the total water quantity the system can be controlled within a reasonable range only by way of mounting a balance valve of a proper specs on each branch and the users access and taking a prim many debugging on it with a special intelligent meter, then looking it, thus setting the unreasonable condition of heavy flow ,small temperature difference.

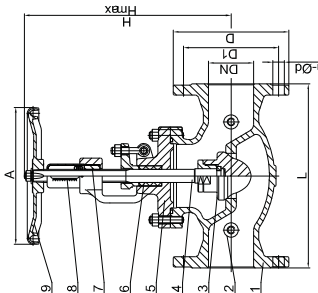

1. 阀体Body
2. 调试接口 Debugging interface
3. 阀芯Core
4. 阀杆Stem
5. 阀盖Bonnet
6. 填料Packing
7. 传动螺母Driving nut
8. 圈数指示牌 Lap number indicator
9. 手轮Handwheel

主要技术参数 Technical specifications for main part

公称通径DN(mm) Nominal diameter	15~600
公称压力PN (MPa) Nominal pressure	1.6
工作温度T (°C) Working temperature	0~100
允许泄漏量 Allowable leakage	A级 GB/T13927-2008

主要零件材料 Material For Main Parts

零件名称 Name of Parts	材质 Material
阀体 Body	铸钢WCB Carbon steel WCB
阀芯 core	不锈钢 Stainless steel
阀杆 Stem	不锈钢20Cr13 Stainless steel
阀盖 Bonnet	铸钢WCB Carbon steel WCB
填料 Packing	聚四氟乙烯PTFE

主要外形尺寸 Main External Dimensions

公称通径 DN(mm) Nominal diameter	15	20	25	32	40	50	65	80	100	125	150	200	250	300	350	400	500	600
L	130	150	160	180	200	230	290	310	350	400	480	495	622	698	787	914	978	1295
D	95	105	115	140	150	165	185	200	220	250	285	340	405	460	520	580	715	840
D1	65	75	85	100	110	125	145	160	180	210	240	295	355	410	470	525	650	770
n-Ød	4-14	4-14	4-14	4-18	4-18	4-18	4-18	4-18	4-18	4-18	4-22	12-22	12-26	12-26	16-26	16-30	20-33	20-36
H	150	160	182	192	250	264	380	413	446	540	623	687	782	914	968	1037	1440	1790
Hmax	160	170	197	207	270	284	410	448	506	595	668	762	867	1009	1073	1152	1540	1890
A	80	180	80	90	100	120	200	240	240	360	400	400	500	500	680	680	800	800

注：法兰标准按GB/T9124.1 RF标准制造，也可按用户指定的标准制造。如JIS、ANSI、DIN。
Note: The manufacturer's standard of the external dimensions implement the GB/T9124.1 RF. The standard of JIS、ANSI、DIN are also available by the clients requirement.

1803

数字锁定平衡阀
Digital Locked Balancing Valve

SP45F

概述

本阀是一种平衡阀，适用于各种液体管路系统，是一种较为理想的新型节能阀门。该阀设有刻度的数字显示，可直观得到任一位置，并可锁定。该阀主要应用于工业和民用建筑采暖管路系统。目前在一些管网系统中存在着水力失调问题，平衡阀提供了解决这一问题的手段，用它可以准确的调节压力和流量，用以改善管网系统中液体流动状况，达到管网液体平衡和节约能源的目的。在双管网工程改造中，应用此阀门可节约能源，得到较好的效果。

Overview

The is a balancing valve, suitable for various liquid pipeline systems, and is an ideal brand-new energy-saving valve, set with a scaled digital display and visually adjustable to any position and lockable. Mainly used for the warming pipeline system of industrial and civil buildings, it provides the means to settle such a problem existing in some pipe-net systems as the hydraulic imbalance and can accurately adjust both side-up and flow so as to improve the flowing status of the liquid inside of the pipe-net system to reach the target of the liquid balancing and energy saving. Use of this valve in the reform of the dual-pipe network engineering can still save energy and get a better effect.

主要技术参数 Technical specifications for main part

公称通径DN(mm) Nominal diameter	32~350
公称压力PN (MPa) Nominal pressure	1.6
工作温度T (°C) Working temperature	0~120
允许泄漏量 Allowable leakage	A级 GB/T13927-2008

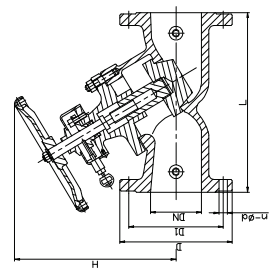

1. 阀体Body
2. 调试接口 Debugging interface
3. 阀芯Core
4. 阀杆Stem
5. 阀盖Bonnet
6. 填料Packing
7. 传动螺母Driving nut
8. 锁定机构Lock mechanism
9. 手轮Handwheel

主要零件材料 Material For Main Parts

零件名称 Name of Parts	材质 Material
阀体 Body	球墨铸铁QT450 Nodular cast iron
阀芯 core	球墨铸铁QT450 Nodular cast iron
阀杆 Stem	不锈钢Cr13 Stainless steel
阀盖 Bonnet	球墨铸铁QT450 Nodular cast iron

主要外形尺寸 Main External Dimensions

公称通径DN(mm) Nominal diameter	40	50	65	80	100	125	150	200	250	300
L	200	215	240	280	310	320	385	465	545	595
D	150	165	180	200	220	250	285	340	405	460
D1	110	125	145	160	180	210	240	295	355	410
n-Ød	4-19	4-19	4-19	4-19	4-19	4-19	4-19	4-19	4-19	4-19
H (mm) 短压差型	242	250	260	329	340	424	454	517	573	617

注：法兰标准按GB/T17241.6 RF标准制造，也可按用户指定的标准制造。如JIS、ANSI、DIN。
Note: The manufacturer's standard of the external dimensions implement the GB/T17241.6 RF. The standard of JIS、ANSI、DIN are also available by the clients requirement.

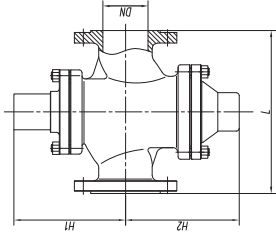

1804 流量控制阀
Flow Control Valve/Self-Balancing Valve ZL47F

技术参数 Technical standard

公称压力: 1.6MPa
公称口径: 40~300mm
适用介质: 水、油类非腐蚀性液体
适用温度: 0~100°C
法兰标准: GB/T 17241.6
试验标准: GB/T 13927

主要零件材料 Material For Main Parts

零件名称 Name of Parts	材质 Material
阀体、阀盖	球铁
阀件	不锈钢/不锈钢钢
膜片	丁腈橡胶

主要外形尺寸 Main External Dimensions

公称口径DN(mm) Nominal diameter	40	50	65	80	100	125	150	200	250	300
L	200	215	225	263	285	295	315	415	430	530
H ₁	138	138	143	170	193	208	254	289	325	357
H ₂	147	147	154	189	211	227	260	303	367	430

注: 法兰标准按GB/T 17241.6 RF标准制造, 也可按用户指定的标准制造, 如JIS, ANSI, DIN。
Note: The manufacturer's standard of the external dimensions implement the GB/T 17241.6 RF. The standard of JIS, ANSI, DIN are also available by the clients requirement.

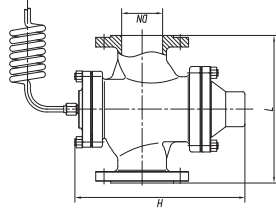

1805 自力式压差控制阀
Pressure Difference Self-Control Valve ZYC

技术参数 Technical standard

公称压力: 1.6MPa
公称口径: 40~300mm
适用介质: 水、油类非腐蚀性液体
适用温度: 0~100°C
压差控制范围: 定压差型 10KPa, 20KPa, 30KPa
法兰标准: GB/T 17241.6
试验标准: GB/T 13927

主要零件材料 Material For Main Parts

零件名称 Name of Parts	材质 Material
阀体、阀盖	灰铸铁、铸钢
阀件	不锈钢/不锈钢钢
膜片	丁腈橡胶

主要外形尺寸 Main External Dimensions

公称口径DN(mm) Nominal diameter	40	50	65	80	100	125	150	200	250	300
L	200	215	225	263	285	295	315	415	430	530
H (mm) 定压差型	190	205	240	300	350	380	453	532	632	728

注: 法兰标准按GB/T 17241.6 RF标准制造, 也可按用户指定的标准制造, 如JIS, ANSI, DIN。
Note: The manufacturer's standard of the external dimensions implement the GB/T 17241.6 RF. The standard of JIS, ANSI, DIN are also available by the clients requirement.



1807

防污隔断阀
Anti-Fouling Stop Valve HS41X

产品概述

防污隔断阀是用于生活饮用水管道中防止污水回流的安全装置, 是我公司引进国外先进技术自行研制开发的新型饮用水阀门。该装置为多只回阀串联而成, 当其中一只被破坏后, 另外两只起密封作用, 多重保护, 杜绝污水回流, 确保饮用水的安全卫生。本阀一般安装在自来水管和分管的连接处或用户水表后面, 用以防止支管的水回流进入主管造成主管网的污染。

Specification

Seepageproof separating valve is the safety device which prevents sewage against back flow into the drinking-water pipeline system. We introduce into the foreign advanced technique and develop the new type drinking-water valve in-dependently. The valve is made up of several check valves when one of the check valve is damaged, the other two check valve will perform the good se-aling-function. We ensure drinking-water safety by multi-protection. The valve is installed in the joint of the main and brand pipe or behind the water meter, which will keep the main pipe network form being polluted by water regultigation.

主要零件材料 Material For Main Parts

零件名称 Name of Parts	材质 Material
阀体 Body	球墨铸铁QT450
阀盖 Bonnet	球墨铸铁QT450
阀盘 Valve Disc	球墨铸铁 Nodular cast iron
弹簧 Spring	不锈钢 Stainless steel
放水阀 A Dirt Discharging Valve	黄铜 Brass

主要技术参数 Technical specifications for main part

公称口径DN (mm) Nominal diameter	50~300
公称压力PN (MPa) Nominal pressure	1.6
工作温度T (°C) Working temperature	≤80
允许泄漏 Allowable leakage	A级 GB/T 13927-2008

主要连接外形尺寸 Main Connection Dimensions

公称口径DN(mm) Nominal diameter	50	65	80	100	125	150	200	250	300
L	458	482	551	653	735	793	1008	1186	1340
H	210	235	264	308	356	400	503	595	705



1808

倒流防止器
Backflow Preventers DH41

主要技术参数

Technical specifications for main part

公称口径DN (mm) Nominal diameter	50~200
公称压力PN (MPa) Nominal pressure	1.6
工作温度T (°C) Working temperature	≤80
允许泄漏 Allowable leakage	A级 GB/T 13927-2008

主要零件材料 Material For Main Parts

零件名称 Name of Parts	材质 Material
阀体 Body	球墨铸铁QT450
阀盖 Bonnet	球墨铸铁QT450
阀盘 Valve Disc	球墨铸铁 Nodular cast iron
弹簧 Spring	不锈钢 Stainless steel
放水阀 A Dirt Discharging Valve	黄铜 Brass

主要连接外形尺寸 Main Connection Dimensions

公称口径DN(mm) Nominal diameter	50	65	80	100	150	200
L	330	345	365	430	475	565
H	210	235	264	308	400	503

1809

水锤吸纳器
Water-hammer Arrestor

XNQ4X

概述 Overview

本产品能在无需阻止流体流动的情况下，有效地消除各类流体在传输系统可能产生的水外锤和浪涌发生的不规则水击震荡，从而达到消除具有破坏性的冲击波，起到保护之目的。水锤吸纳器内部有一密封的袋气囊，下端为一活塞。当冲击波传入水锤吸纳器时，水击波作用于气囊上，活塞将往气囊内方向运动，活塞运动的行程与气囊内气体的压力、水击波大小有关，活塞在一定压力的气体和不规则水击波作用下，做上下运动，形成一个动态的平衡，这样就有效地消除了不规则的水击波震荡。



性能参数 Performance parameter

公称通径DN (mm) Nominal diameter	40~300
公称压力PN (MPa) Nominal pressure	1.6
工作温度T (°C) Working temperature	0~80

主要零件材料 Material For Main Parts

零件名称 Name of Parts	材质 Material
筒体 Valve Body	不锈钢06Cr19Ni10 Stainless Steel
活塞 Plunger	尼龙 Nylon
弹簧 Spring	不锈钢06Cr19Ni10 Stainless Steel

1806

橡胶软接头
Flexible Rubber Joint

KDTF

概述 Overview

橡胶接头又称可挠橡胶接头，橡胶柔性接头，橡胶柔性接头，软接头，减振器，减振减振器，减震器等。是一种高弹性、高气密性、耐介质性和耐气候性的管道接头。该产品利用了橡胶的弹性、高气密性、耐介质性、耐候性和耐辐照性等有点，采用高强度、冷态稳定性强的聚脲纤维斜交与之复合后，经过高压、高温模具硫化而成。

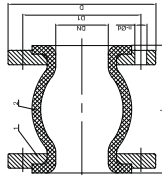

性能参数 Performance parameter

公称通径DN (mm) Nominal diameter	32~300
公称压力PN (MPa) Nominal pressure	1.6
工作温度T (°C) Working temperature	0~80

主要零件材料 Material For Main Parts

零件名称 Name of Parts	材质 Material
法兰 Flange	碳钢 Carbon steel
接头 Joint	三元乙丙橡胶EPDM

主要外形尺寸 Main External Dimensions

公称通径DN (mm) Nominal diameter	32	40	50	65	80	100	125	150	200	250	300
L	95	105	115	130	135	170	180	190	240	260	260
D	140	150	165	180	200	220	250	285	340	405	460
D1	100	110	125	145	160	180	210	240	295	355	410
n-φd	4-19	4-19	4-19	4-19	8-19	8-19	8-19	8-23	12-23	12-28	12-28
轴位移 displacement (mm)	6	6	7	7	8	10	12	12	16	16	16
伸长 Elongation	9	10	10	13	15	19	19	20	25	25	25
轴向位移 Axial displacement	9	9	10	12	12	13	13	14	22	22	22
轴向位移 Axial displacement (d1+d2)	24±j	15	15	15	15	15	15	15	15	15	15

注：法兰标准按GB/T17241.6 RF标准制造，也可按用户指定的标准制造，如JIS、ANSI、DIN。

Note: The manufacturer's standard of the external dimensions implement the GB/T17241.6 RF. The standard of JIS、ANSI、DIN are also available by the clients requirement.



3802

减震式波纹补偿器
Corrugated Compensator

HYBN

性能参数 Performance parameter

公称通径DN (mm) Nominal diameter	40~300
公称压力PN (MPa) Nominal pressure	1.6
工作温度T (°C) Working temperature	-20~200
允许泄流量 Allowable leakage	GB/T 13927-2008

主要零件材料 Material For Main Parts

零件名称 Name of Parts	材质 Material
法兰 Flange	碳钢 Carbon steel
螺栓 Bolt	碳钢 Carbon steel
螺母 Nut	碳钢 Carbon steel
波纹管 Corrugated pipe	不锈钢 Stainless steel

主要外形尺寸 Main External Dimensions

公称通径DN (mm) Nominal diameter	40	50	65	80	100	150	200	250	300
L	150	155	225	235	300	300	400	400	450
伸缩量 (mm)	±15	±15	±20	±29	±44	±70	±110	±115	±120

注：法兰标准按GB/T19124.1 RF标准制造，也可按用户指定的标准制造，如JIS、ANSI、DIN。
Note: The manufacturer's standard of the external dimensions implement the GB/T 19124.1 RF. The standard of JIS、ANSI、DIN are also available by the clients requirement.

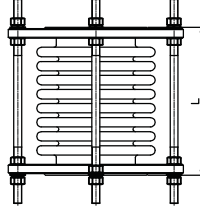

3808

限位伸缩器
Limit extender

VSSJA

性能参数 Performance parameter

公称通径DN (mm) Nominal diameter	65~400
公称压力PN (MPa) Nominal pressure	1.6
工作温度T (°C) Working temperature	0~100
允许泄流量 Allowable leakage	GB/T 13927-2008

主要零件材料 Material For Main Parts

零件名称 Name of Parts	材质 Material
限位法兰 Limit flange	碳钢 Carbon steel
螺栓 Bolt	碳钢 Carbon steel
螺母 Nut	碳钢 Carbon steel
法兰 Flange	碳钢 Carbon steel

主要外形尺寸 Main External Dimensions

公称通径DN (mm) Nominal diameter	65	80	100	125	150	200	250	300	350	400
L	340	340	340	340	340	340	340	350	350	350
伸缩量 (mm)	50	50	50	50	50	50	50	65	50	50

注：法兰标准按GB/T19124.1 RF标准制造，也可按用户指定的标准制造，如JIS、ANSI、DIN。
Note: The manufacturer's standard of the external dimensions implement the GB/T 19124.1 RF. The standard of JIS、ANSI、DIN are also available by the clients requirement.

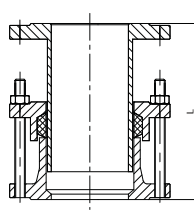

2101

不锈钢丝口闸阀
Stainless steel threaded gate valve

Z15W

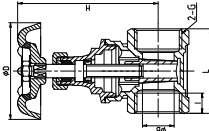

性能参数 Performance parameter

圆柱管螺纹标准	BSPP Standard				符合ISO228标准			
公称压力PN (MPa)	Nominal pressure				1.6MPa			
工作温度T (°C)	Working temperature				0≤t≤80°C			
工作介质	Working Medium				水、非腐蚀性液体			

主要外形尺寸 Main External Dimensions

公称通径DN(mm) Nominal diameter	L	I	B	D	H	G
15	44	11.5	12	54	75.6	1/2
20	48	11.5	17	54	82	3/4
25	52	13	22	62.5	95	1
32	56.5	13	28	64	108.5	1¼
40	62.5	15	35	73	124.5	1½
50	67	15	45	77	145	2

2104

不锈钢丝口闸阀(软)
Stainless steel threaded gate valve

Z15X

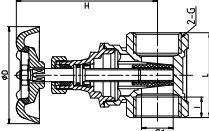

性能参数 Performance parameter

圆柱管螺纹标准	BSPP Standard				符合ISO228标准			
公称压力PN (MPa)	Nominal pressure				1.6MPa			
工作温度T (°C)	Working temperature				0≤t≤80°C			
工作介质	Working Medium				水、非腐蚀性液体			

主要外形尺寸 Main External Dimensions

公称通径DN(mm) Nominal diameter	L	I	B	D	H	G
15	44	11.5	12	54	75.6	1/2
20	48	11.5	17	54	82	3/4
25	52	13	22	62.5	95	1
32	56.5	13	28	64	108.5	1¼
40	62.5	15	35	73	124.5	1½
50	67	15	45	77	145	2

2103

不锈钢机械锁式闸阀
Stainless steel mechanical lockable gate valve

Z15W

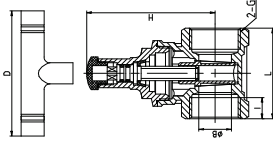

性能参数 Performance parameter

圆柱管螺纹标准	BSPP Standard				符合ISO228标准			
公称压力PN (MPa)	Nominal pressure				1.6MPa			
工作温度T (°C)	Working temperature				0≤t≤80°C			
工作介质	Working Medium				水、非腐蚀性液体			

主要外形尺寸 Main External Dimensions

公称通径DN(mm) Nominal diameter	L	I	B	D	H	G
15	44	11.5	12	65	65	1/2
20	48	11.5	17	65	74	3/4
25	52	13	22	65	86	1
32	56.5	13	28	70	91.5	1¼
40	62.5	15	35	70	112	1½
50	67	15	45	70	132.5	2

2267

不锈钢丝口球阀
Stainless steel threaded ball valve

Q11F

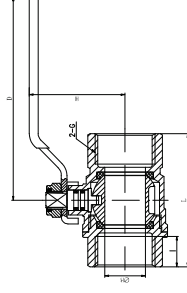

性能参数 Performance parameter

圆柱管螺纹标准	BSPP Standard				符合ISO228标准			
公称压力PN (MPa)	Nominal pressure				1.6MPa			
工作温度T (°C)	Working temperature				0≤t≤80°C			
工作介质	Working Medium				水、非腐蚀性液体			

主要外形尺寸 Main External Dimensions

公称通径DN(mm) Nominal diameter	L	I	B	D	H	G
15	62.6	12.5	15	90	43	1/2
20	70.5	15.5	20	98	47.5	3/4
25	81	15.5	25	114	56.5	1
32	94	18	32	121.5	61.3	1¼
40	103	18	40	134	76.3	1½
50	120	20	50	165	86	2

2311

不锈钢丝口截止阀
Stainless steel threaded stop valve

J11W



性能参数 Performance parameter

圆柱管螺纹标准	BSPP Standard	符合ISO228标准
公称压力PN (MPa)	Nominal pressure	1.6MPa
工作温度T (°C)	Working temperature	0≤t≤80°C
工作介质 Working Medium		水、非腐蚀性液体

主要外形尺寸 Main External Dimensions

公称通径DN(mm) Nominal diameter	L	I	D	H	G
15	60	10.5	64	99	1/2
20	68	10.5	64	112	3/4
25	79	13.5	73	118	1
32	88	13.5	77	125	1 ¹ / ₄
40	117	18	98	155.5	1 ¹ / ₂
50	165	18	98	163	2

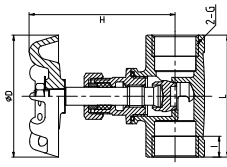

2403

不锈钢旋启式止回阀
Stainless steel threaded check valve

H14W



性能参数 Performance parameter

圆柱管螺纹标准	BSPP Standard	符合ISO228标准
公称压力PN (MPa)	Nominal pressure	1.6MPa
工作温度T (°C)	Working temperature	0≤t≤80°C
工作介质 Working Medium		水、非腐蚀性液体

主要外形尺寸 Main External Dimensions

公称通径DN(mm) Nominal diameter	L	B	H	G
15	62.3	15	42	1/2
20	74.5	20	48	3/4
25	83.5	24	49.5	1
32	98	31	56	1 ¹ / ₄
40	113.5	38	64	1 ¹ / ₂
50	133	45	76	2

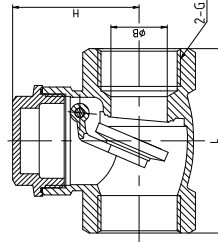

2606

不锈钢Y型过滤器
Stainless steel threaded strainer

GL11W



性能参数 Performance parameter

圆柱管螺纹标准	BSPP Standard	符合ISO228标准
公称压力PN (MPa)	Nominal pressure	1.6MPa
工作温度T (°C)	Working temperature	0≤t≤80°C
工作介质 Working Medium		水、非腐蚀性液体

主要外形尺寸 Main External Dimensions

公称通径DN(mm) Nominal diameter	H	L	G
15	53	59.5	1/2
20	67	75	3/4
25	78	82	1
32	90	102	1 ¹ / ₄
40	100	106	1 ¹ / ₂
50	120	123.5	2

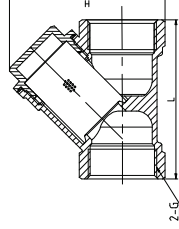

2737

不锈钢丝口减压阀
Stainless steel threaded stop valve

Y13X



性能参数 Performance parameter

圆柱管螺纹标准	BSPP Standard	符合ISO228标准
公称压力PN (MPa)	Nominal pressure	1.6MPa
工作温度T (°C)	Working temperature	0≤t≤80°C
工作介质 Working Medium		水、非腐蚀性液体

主要外形尺寸 Main External Dimensions

公称通径DN(mm) Nominal diameter	L	B	H ₁	H ₂	G
15	71.3	19	29.5	65.5	1/2
20	75.3	23	30	69	3/4
25	85.3	31	37.5	81.5	1
32	90	39	42	90	1 ¹ / ₄
40	101	44	44	111	1 ¹ / ₂
50	125	55	55	123.5	2

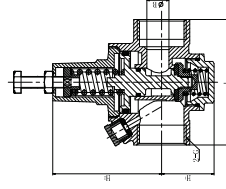

- 在产品保修期内及寿命期之内保证提供需方所需的备品备件。
- 我方保证需方的时间要求，选派专业的工程技术人员进行产品安装现场协助安装、调试工作，直到产品正常使用。
- 急用户所急，想用户所想，备有大量库存，随时满足客户需求，做到库房搬到家，服务做到家的宗旨。
- Offer the store what our customer demand in the period of guarantee.
- Detail the professional technician help the customers setting and debugging the professional technician.
- We think what our customers think, our company has a mass of in stock, and we are satisfied your demands momentarily. We can offer our product and service to where you demands.

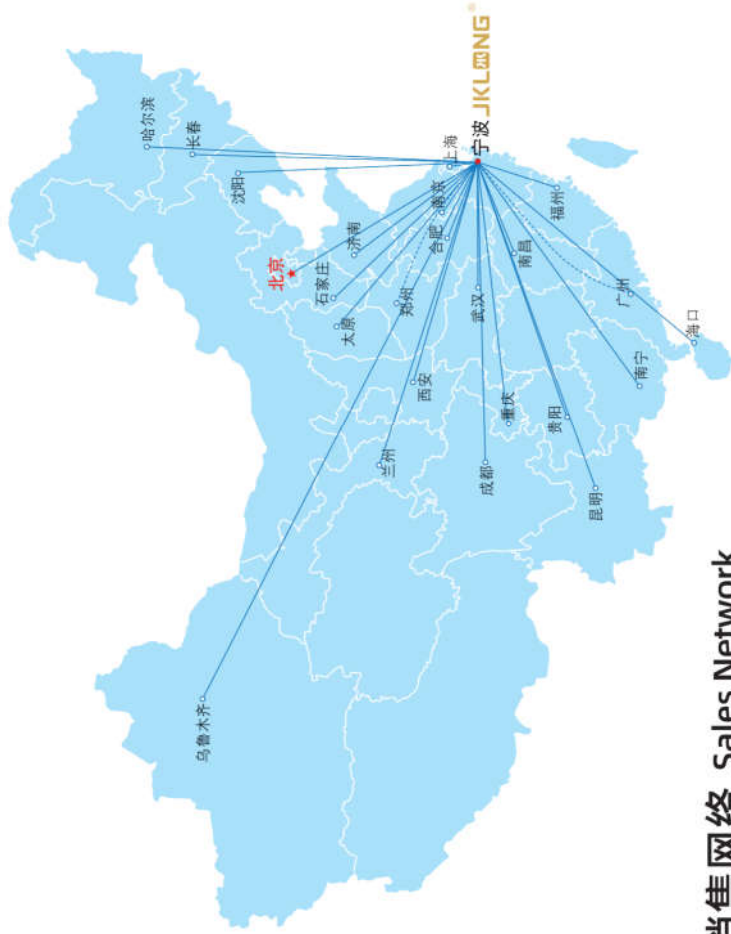

销售网络 Sales Network

本着合作、创新、优质服务和健康的经营理念，建立健全完善的销售网络，配合高效率务实的销售团队，提供良好的售后服务。

目前公司销售网络遍布全国32个省市自治区，在北京、上海、广州、重庆、南京、郑州、沈阳、福州、杭州、长沙、济南等地设立了分公司或办事处，销售网点近500家，保证产品的及时送达，提供优质周到的送货及售后服务。

We observe cooperation, innovations, high-quality services and healthy business concept has established a perfect sales network, and with efficient and practical sales team, provide excellent aftersales services.

Jiekelong has sales network which covers 32 provinces and municipalities, set up branch office in Beijing, Shanghai, Guangzhou, Chongqing, Nanjing, Zhengzhou, Shenyang, Fuzhou, Hangzhou, Changsha, Jinan and etc., which in total open about 500 sales outlets. In this way, we can provide you on-time delivery and excellent after-sales service.